

DA8700 with Universal- and Quick Mounting Plate

Acura	Type	Model	Year	Front	Rear	Max	Min	Drawing	Shim	QMP	Remarks
Acura									(mm)		
Acura	2.2CL, 2.3CL, 3.0CL	YA		F		23	21	G	5	SK-521B	
Acura	Vigor	CC		F		23	21	G	5	SK-521B	
Acura	2.5TL, 3.2 TL	UA		F		23	21	G	5	SK-521B	
Acura	Integra	AD, DB, DC		F		23	21	A	8	SK-521B	
Acura					R	9	7	G	5		Use short uni.plates SK-532A
Acura	3.5RL	KA		F		23	21	G	5	SK-521B	
Acura				F		28	26	G	5	SK-521B	
Acura					R	9.5	7.5	M	12		
Acura	SLX			F		26	24.6	G	10	SK-542	
Acura					R	18	16.6	G	7		
Acura	CL		2002	F							
Acura					R	9	7.5				
Acura	RL	KA	2004	F							
Acura					R	9	7.5				
Acura	RL	KB1	2005	F							
Acura					R						
Acura	TL		2002	F							
Acura					R	9	7.5				
Acura		Automatic	2004	F		28	26				
Acura		Manual		F		25	23				
Acura					R	9	7.5				
Acura	TSX		2004	F							
Acura					R	10	8				
Acura	RSX		2004	F							
Acura					R	10	8				
Acura	NSX		2004	F		28	26				
Acura					R	21	19				
Acura	MDX		2003	F							

Alfa Romeo	Type	Model	Year	Front	Rear	Max	Min	Drawing	Shim	QMP	Remarks
Alfa Romeo									(mm)		
Alfa Romeo	145		1994..2000	F		20	18.2	F	None		

DA8700 with USM

USM	Remarks
USM2002-R2	
USM2002-R2	
USM2002-R2	
USM2002-B3	
USM2002-R2	
USM2002-R2	
USM2002-R2	
USM2002-R2	
USM2002-R2	
USM2002-R2	
USM2002-R2	Use SK-572 with USM
USM2002-R2	
USM2002-R2	
USM2002-R2	
USM2002-R2	
USM2002-R2	
USM2002-R2	
USM2002-R2	
USM2002-R2	
USM2002-R2	
USM2002-R2	
USM2002-R2	Use extensions 220000RL
USM2002-R2	

USM	Remarks
USM2002-R2	Use extensions 220000RL

DA2002 with USM

USM	Remarks
USM2002-R2	
USM2002-R2	
USM2002-R2	
USM2002-B3	
USM2002-R2	
USM2002-R2	
USM2002-R2	
USM2002-R2	
USM2002-R2	
USM2002-R2	
USM2002-R2	Use SK-572 with USM
USM2002-R2	
USM2002-R2	
USM2002-R2	
USM2002-R2	
USM2002-R2	
USM2002-R2	
USM2002-R2	
USM2002-R2	
USM2002-R2	Use extensions 220000RL
USM2002-R2	

USM	Remarks
USM2002-R2	

Alfa Romeo					R	11	9.2	H	3			USM2002-R2		USM2002-R2
Alfa Romeo	147		2000..2010	F		22	20	G	8	SK-543		USM2002-R2	Use extensions 220000RL	USM2002-R2
Alfa Romeo					R	10	9					x		USM2002-R2      Use M10x20 bolts
Alfa Romeo	164 ts		1987..1998	F		22.0	20.2	F	None			USM2002-R2		USM2002-R2
Alfa Romeo	156		1997..2007	F		22.2	20.2	G	8			USM2002-R2	Use extensions 220000RL	USM2002-R2
Alfa Romeo						10	9					x	No space	x
Alfa Romeo	159		2005..2011	F								USM2002-R2	Use extensions 220000RL	USM2002-R2
Alfa Romeo	166		1998..2007	F								USM2002-R2		USM2002-R2
Audi	Type	Model	Year	Front	Rear	Max	Min	Drawing	Shim (mm)	QMP	Remarks	USM	Remarks	USM      Remarks
Audi	80	avant	90..	F		22	20	B	3			USM2002-B3		USM2002-B3
Audi					R	10	8	B	10			USM2002-B3		USM2002-B3
Audi			91..93	F		13	11	B	13			USM2002-B3		USM2002-B3
Audi	100		82..92	F		13	11	B	13			USM2002-B3		USM2002-B3
Audi	A2		2000..	F		22	19	C	13		Use M9 bolts SK-411 on caliper	Use SK-411 and Use universal plates		USM2002-B3      Use SK-411, SK-423 and universal plates
Audi	A3			F		22	18	C	12		Use M9 bolts SK-411 on caliper,	Use SK-411, SK-420 and universal plates		USM2002-B3      Use SK-411, SK-420, SK-423 and universal plates
Audi					R	9	7	G	17			USM2002-R2		USM2002-R2
Audi			2003	F		25	22	G	10			USM2002-R2		USM2002-R2
Audi	A4	8D		F		13	11	B	13			USM2002-B3		USM2002-B3
Audi		8D		F		25	23	B	7	SK-553		USM2002-B3		USM2002-B3
Audi		8D			R	10	8	F	None			USM2002-R2		USM2002-R2
Audi		Quattro			R	10	8	F	None			USM2002-R2	Use extensions 220000RL	USM2002-R2      Use extensions 220000RL
Audi	A4	RS4		F								USM2002-R2		USM2002-R2      Use extensions 220000RL
Audi		8E		F		25	23	G	12			USM2002-R2	Use extensions 220000RL	USM2002-R2      Use extensions 220000RL
Audi		8E			R	12	10	F	None			USM2002-R2	Use extensions 220000RL	USM2002-R2      Use extensions 220000RL
Audi	A6		94..	F		25	23	B	7			USM2002-B3		USM2002-B3
Audi					R	10	8	H	3			H		x
Audi	A6		2004..	F		30	28	G	12		Use UP-RL1	USM2002-R2	Use extensions 220000RL	USM2002-R2      Use extensions 220000RL
Audi					R	12	10	G	3			USM2002-R2	Use extensions 220000RL, shim 7 mm and turn bow	USM2002-R2      Use extensions 220000RL, shim 7 mm and turn bow
Audi	A8		96..	F				N	5			USM2002-B3	Use extensions 220000BBL	USM2002-B3      Use extensions 220000BBL
Audi			2003	F		34	31	M	20		Use UP-BL1	M		USM2002-R2      Use extensions 220000RL
Audi					R	22	20	G	8			USM2002-R2	Use extensions 220000RL	USM2002-R2      Use extensions 220000RL
Audi	S8			F		30	28	-	-	SK-587B	Use SK-587B and SK-414A	Use SK-587B and SK- 414A. Drawing AA		Use SK-587B and SK- 428. Drawing AK
Audi					R	22	20	F	None			USM2002-R2	Use extensions 220000RL	USM2002-R2      Use extensions 220000RL

Audi	TT		98..	F		25	23	-	-	SK-553		USM2002-B3	Use extensions 220000BL	USM2002-B3	
Audi	Q7	Ø350		F		34	32				Use USM ->	USM2002-B3	Use extensions 220000BL, drill hole to 16 mm	USM2002-B3	Use extensions 220000BL, drill hole to 16 mm
Audi		Ø330			R	28	26	P		3	Mount uni Yellow with original calliper bolts.	USM2002-B3		USM2002-B3	
Ausa	Type	Model	Year	Front	Rear	Max	Min	Drawing	Shim (mm)	QMP	Remarks	USM	Remarks	USM	Remarks
Ausa	Multitask	M250 H	2006	F		22	20	G	17		Use SK-570	USM2002-R2	Use SK-570	USM2002-R2	Use SK-570
Bitter	Type	Model	Year	Front	Rear	Max	Min	Drawing	Shim (mm)	QMP	Remarks	USM	Remarks	USM	Remarks
Bitter	SC	3.0		F		24						USM2002-B3		USM2002-B3	
Bitter					R	10						USM2002-B3	Turn bow	USM2002-B3	Turn bow
BMW	Type	Model	Year	Front	Rear	Max	Min	Drawing	Shim (mm)	QMP	Remarks	USM	Remarks	USM	Remarks
BMW	1 serie	E87	04..	F		22.0	20.4	G	15	SK-541		USM2002-R2		USM2002-R2	
BMW					R	10.0	8.0				Use SK-532A	Use SK-532A		USM2002-R2	
BMW					R	20.0	18.4				Use SK-532A	Use SK-532A		USM2002-R2	
BMW	3 serie	E30	82..93	F		12.7	11.1	G	8			USM2002-R2		USM2002-R2	
BMW		E36	90..98	F		12.0	10.4	G	12	SK-541		USM2002-R2		USM2002-R2	
BMW		E36	90..98	F		22.0	20.4	G	15	SK-541		USM2002-R2		USM2002-R2	
BMW					R	10.0	8.4	F	None			USM2002-R2		USM2002-R2	
BMW		E46	98..	F		22.0	20.4	G	15	SK-541		USM2002-R2		USM2002-R2	
BMW					R	10.0	8.4	F	None			USM2002-R2		USM2002-R2	
BMW	5 serie	E34	88..96	F		12.0	10.4	G	18	SK-555		USM2002-R2		USM2002-R2	
BMW		E34	88..96	F		22.0	20.4	G	23	SK-555		USM2002-R2		USM2002-R2	
BMW		E34	88..96	F		28.0	26.4	G	23	SK-555		USM2002-R2		USM2002-R2	
BMW					R	10.0	8.4	F	None			USM2002-R2		USM2002-R2	
BMW		E39	96..	F		22.0	20.4	G	22	SK-555		USM2002-R2		USM2002-R2	
BMW					R	10.0	8.4	G	3			USM2002-R2		USM2002-R2	
BMW					R	20.0	18.4	G	5			USM2002-R2		USM2002-R2	
BMW		E60/E61	03..	F		24.0	22.4	G	20	SK-525		USM2002-R2		USM2002-R2	
BMW					R	20.0	18.4	M	23			USM2002-R2		USM2002-R2	
BMW	7 serie	E32	86..94	F		28.0	26.4	L	10	SK-555		USM2002-R2		USM2002-R2	
BMW					R	20.0	18.4	G	7			USM2002-R2		USM2002-R2	
BMW		E38	94..	F		28.0	26.4	L	10	SK-555		USM2002-R2		USM2002-R2	
BMW					R	12.0	10.4	G	3			USM2002-R2		USM2002-R2	
BMW		E65	01..	F		30.0	28.4	G	22			USM2002-R2		USM2002-R2	
BMW					R	20.0	18.4	M	22	SK-547		USM2002-R2		USM2002-R2	
BMW	8 serie	E31	89..99	F		30.0	27.0	G	22			USM2002-R2		USM2002-R2	
BMW					R	12	10.8	G	3			G		USM2002-R2	
BMW	X3	E83	03..	F		25.0	23.4	G	22	SK-525		USM2002-R2		USM2002-R2	

BMW					R	22.0	20.4	M	15	SK-547		USM2002-R2		USM2002-R2	
BMW	X5	E53	99..	F		30.0	28.4	G	22			USM2002-R2		USM2002-R2	
BMW					R	12.0	10.4	G	3			USM2002-R2		USM2002-R2	
BMW	Z4	E85	02..	F		22.0	20.4	G	15	SK-541		USM2002-R2		USM2002-R2	
BMW					R	10.0	8.4	F	NONE	SK-547		USM2002-R2		USM2002-R2	
Cadillac	Type	Model	Year	Front	Rear	Max	Min	Drawing	Shim (mm)	QMP	Remarks	USM		Remarks	
Cadillac												USM		Remarks	
Cadillac	BLS		2005	F		25	22	D	7			USM2002-B3		Use extensions 220000BL	
Cadillac					R	10	8	B	12	SK-535		USM2002-B3		USM2002-B3	
Cadillac	CTS		2001	F		32	30	L	3			USM2002-R2		Use extensions 220000RL	
Cadillac					R	26	24	G	13			USM2002-R2		USM2002-R2	
Cadillac	STS Seville		1997	F		32	30	L	3			USM2002-R2		Use extensions 220000RL	
Cadillac					R	10.2	8	G	8			USM2002-R2		Use extensions 220000RL, turn bow	
Cadillac	Escalade ESV		2003	F		29						USM2002-R2		Use extensions 220000RL	
Cadillac	Escalade EXT		2003	F		29						USM2002-R2		Use extensions 220000RL	
Chevrolet	Type	Model	Year	Front	Rear	Max	Min	Drawing	Shim (mm)	QMP	Remarks	USM		Remarks	
Chevrolet												USM		Remarks	
Chevrolet	Matiz		2005..	F		12.7	10	F	None	SK-523		USM2002-R2		USM2002-R2	
Chevrolet	Kalos		2005..	F		20	18	G	5	SK-523		USM2002-R2		USM2002-R2	
Chevrolet	Nubira		2005..2006	F		24	22	G	7	SK-523		USM2002-R2		USM2002-R2	
Chevrolet					R	10.5	10	G	3			USM2002-R2		USM2002-R2	
Chevrolet	Nubira		2006..	F		24	22	G	5			USM2002-R2		USM2002-R2	
Chevrolet					R	10.5	10				Use SK-532A and SK-425	Use SK-532A and SK- 425		USM2002-R2	
Chevrolet	Lacetti		2005..	F		24	22	G	7	SK-523		USM2002-R2		USM2002-R2	
Chevrolet					R	10.5	10	G	3			USM2002-R2		USM2002-R2	
Chevrolet	Evanda		2005..	F		24	22	G	7	SK-523		USM2002-R2		USM2002-R2	
Chevrolet					R	12	10	G	5			USM2002-R2		USM2002-R2	
Chevrolet	Epica		2006..	F		24	22	G	7	SK-523		USM2002-R2		USM2002-R2	
Chevrolet					R	12	10	G	5			USM2002-R2		USM2002-R2	
Chevrolet	Tacuma		2005..	F		24	22	G	7			USM2002-R2		USM2002-R2	
Chevrolet	Orlando		2011..	F		26	24	G				USM2002-R2		USM2002-R2	
Chevrolet					R	12	10	G				USM2002-R2		USM2002-R2	
Chevrolet	Zafira			F		25	22	D	7			USM2002-B3		USM2002-B3	
Chevrolet	Corvette		2003	F		32	30	L	5			USM2002-R2		USM2002-R2	
Chevrolet					R	21	19	G	10		Machine only in drive direction	USM2002-R2		USM2002-R2	
Chevrolet	Captiva		2006..	F		29	27	G	8			USM2002-R2		Use extensions 220000RL	
Chevrolet					R	20	18.4					USM2002-R2		USM2002-R2	

Chevrolet	Tracker			F		22	20	G	13	SK-521B	Use 4WD drive adapter SK-509C	USM2002-R2		USM2002-R2			
Chevrolet	Blazer	T105-16		F		29.2		K		None	Use SK-407 bolts	USM2002-R2		USM2002-R2			
Chevrolet	Trans sport		2000	F		32		M	25			USM2002-R2		USM2002-R2			
Chevrolet					R	11		G	7	SK-527A		USM2002-R2		USM2002-R2			
Chevrolet	Trans sport	Versatrek AWD	2000	F		30		G	13			USM2002-R2		Use extensions 220000RL	USM2002-R2		
Chevrolet					R	11		G	10			USM2002-R2		USM2002-R2			
Chevrolet	Venture		2000	F		32		M	25			USM2002-R2		USM2002-R2			
Chevrolet					R	11		G	7	SK-527A		USM2002-R2		USM2002-R2			
Chevrolet	Venture	Versatrek AWD	2000	F		30		G	13			USM2002-R2		Use extensions 220000RL	USM2002-R2		
Chevrolet					R	11		G	10			USM2002-R2		USM2002-R2			
Chevrolet	Trailblazer		2003	F		29		G	20			USM2002-R2		USM2002-R2			
Chevrolet	Avalanche		2003	F		29						USM2002-R2		Use extensions 220000RL	USM2002-R2		
Chevrolet	Tahoe		2003	F		29						USM2002-R2		Use extensions 220000RL	USM2002-R2		
Chevrolet	Suburban		2003	F		29						USM2002-R2		Use extensions 220000RL	USM2002-R2		
Chevrolet	G Van	2500	1990	F		32.5	31.3	C	7			USM2002-B3		USM2002-B3			
Chevrolet	G Van	2500 JD7 diesel	2001..2003	F		38.1	37.6	H	6			USM2002-B3		Use shorter bolts with same thread or remove spacer from spare kit of original bolts and use with shorter and wider spacer	USM2002-B3	Use shorter bolts with same thread or remove spacer from spare kit of original bolts and use with shorter and wider spacer.	
Chevrolet	Express		2004..	F								USM2002-R2		Use extensions 220000RL	USM2002-R2	Use extensions 220000RL	
Chrysler	Type	Model	Year	Front	Rear	Max	Min	Drawing	Shim (mm)	QMP	Remarks	USM		Remarks	USM		Remarks
Chrysler	Neon	PL		F		20.0	18.4	E	13	SK-545		USM2002-B3		USM2002-B3			
Chrysler				F		22.0	20.4	E	13	SK-545		USM2002-B3		USM2002-B3			
Chrysler					R	9.0	7.25	E	3			USM2002-B3		USM2002-B3			
Chrysler	Stratus	JA, JX		F		23.0	21.4	E	10	SK-544A		USM2002-B3		USM2002-B3			
Chrysler					R	9.0		E	3			USM2002-B3		USM2002-B3			
Chrysler	Sebring	JR		F		23.0	21.4	G	25			USM2002-R2		USM2002-R2			
Chrysler					R	9.0	7.25	C	3			C		C			
Chrysler	Vision	LH		F		24.0	22.4	E	13	SK-545		USM2002-B3		USM2002-B3			
Chrysler					R	12.0	10.4	E	3			USM2002-B3		USM2002-B3			
Chrysler	300M	LH		F		26.0	24.4	E	13	SK-545		USM2002-B3		USM2002-B3			
Chrysler					R	12.0	10.4	E	3			USM2002-B3		USM2002-B3			
Chrysler	300 / 300C / 300C AWD		2004..	F		28.0	26.5	Q	22		Use 14 conical rings TM64001	USM2002-R2		Use extensions 220000RL	USM2002-R2	Use extensions 220000RL	
Chrysler					R	22.0	20.5	E	3		Use 14 conical rings TM64001	USM2002-B3		USM2002-B3			

Chrysler	Crossfire			F		28.0	25.4	G	18	SK-524	Use 9 conical rings TM64001	USM2002-R2		USM2002-R2		
Chrysler				R		9.0	7.3	B	13		Use 14 conical rings TM64001	USM2002-B3		USM2002-B3		
Chrysler	New Yorker	L		F		24.0	22.4	E	13	SK-545		USM2002-B3		USM2002-B3		
Chrysler				R		12.0	10.4	E	3			USM2002-B3		USM2002-B3		
Chrysler	Le Baron	J		F		23.0	21.4	E	18	SK-545		USM2002-B3		USM2002-B3		
Chrysler				R		12.0	10.4	E	7			USM2002-B3		USM2002-B3		
Chrysler	PT Cruiser	PT		F		24.0	22.4	G	10	SK-568		USM2002-R2	Use extensions 220000RL	USM2002-R2		
Chrysler	Voyager	ES, AS		F		24.0	22.4	E	17	SK-545		USM2002-B3		USM2002-B3		
Chrysler		GS, NS		F		24.0	22.4	E	15	SK-545		USM2002-B3		USM2002-B3		
Chrysler				R		12.25	11.25	C	3			USM2002-B3		USM2002-B3		
Chrysler		RG		F		28	25.3	G	13			USM2002-R2		USM2002-R2		
Chrysler				R		12.6	11.25	A	None		Use M9 bolts SK-411 on caliper	USM2002-B3	Use SK-411	USM2002-B3	Use M9 bolts SK-411 on caliper	
Citroën	Type	Model	Year	Front	Rear	Max	Min	Drawing	Shim (mm)	QMP	Remarks	USM		Remarks		
Citroën	AX		1988..1991	F		8	6	D	13	SK-526	Use spacer SK-401 for upper caliper	USM2002-B3		USM2002-B3		
Citroën	Saxo		1996..2003	F		10	8	D	10	SK-554		USM2002-B3		USM2002-B3		
Citroën				F		20.4	18.5	B	5	SK-554		USM2002-B3		USM2002-B3		
Citroën	C1		2006..2014	F		20	18	G	7	SK-522A		USM2002-R2		USM2002-R2		
Citroën	C3		2002..2010	F		13	11	A	None	SK-554		USM2002-B3		USM2002-B3		
Citroën	C3 Pluriel		2003	F		22	20	A	None	SK-554		USM2002-B3		USM2002-B3		
Citroën	C3 Picasso		2009..	F		22	10					USM2002-B3		USM2002-B3		
Citroën				R		9	8					USM2002-R2		USM2002-R2		
Citroën	Cactus		2014..	F								USM2002-B3		USM2002-B3		
Citroën	BX		1982..1992	F		10	7	D	8	SK-526		USM2002-B3		USM2002-B3		
Citroën				R		7	4	-	-	SK-561	Use SK-561, SK-411, SK-402, shim 10 mm	Use SK-561, SK-411, SK-402, shim 10 mm		Use SK-561, SK-411, SK-402, shim 8 mm		
Citroën	ZX		1991..1998	F		10	8	B	13	SK-526		USM2002-B3		USM2002-B3		
Citroën				F		20.4	18.4	B	5	SK-526		USM2002-B3		USM2002-B3		
Citroën	Xsara		1996..2006	F		20.4	18.4	B	5	SK-526		USM2002-B3		USM2002-B3		
Citroën	Xantia		1993..2002	F		22	20	B	5	SK-526		USM2002-B3	Use shim 10 mm	USM2002-B3	Use shim 10 mm	
Citroën				R		9	7	-	-	SK-561	Use SK-561, SK-411, SK-402, shim 10 mm	Use SK-561, SK-411, SK-402, shim 10 mm		Use SK-561, SK-411, SK-402, shim 8 mm		
Citroën	XM		1989..2000	F		22	20	G	7	SK-554		USM2002-R2		USM2002-R2		
Citroën				R		9	7	-	-	SK-561	Use SK-561, SK-411, SK-402, shim 10 mm	Use SK-561, SK-411, SK-402, shim 10 mm		Use SK-561, SK-411, SK-402, shim 8 mm		

Citroën	Evasion	U60	1994..2002	F		26.0	24.0	G	8	SK-543		USM2002-R2	Use extensions 220000RL	USM2002-R2	
Citroën	C15		1985..2015	F		9.1	8.1	B	10			USM2002-B3		USM2002-B3	
Citroën		diesel	1985..2015	F		10.0	8.0	B	13	SK-526		USM2002-B3		USM2002-B3	
Citroën	C35		1987..1992	F		20	18	A	None			USM2002-B3		USM2002-B3	
Citroën					R	9	7	B	5			USM2002-B3		USM2002-B3	
Citroën	Nemo		2008..	F		22	20	G	10			USM2002-R2		USM2002-R2	
Citroën	Berlingo		1996..2002	F		20.4	18.4	C	3	SK-526		USM2002-B3		USM2002-B3	
Citroën	Berlingo		2003..2008	F		22	20	B	3	SK-526		USM2002-B3		USM2002-B3	
Citroën			2008..	F		26	24	A	None			USM2002-B3		USM2002-B3	
Citroën					R	12	10	G	17			USM2002-R2	Use extensions 220000RL	USM2002-R2      Use extensions 220000RL	
Citroën	Jumpy		1996..2007	F		20.4	18.2	G	10	SK-543		USM2002-R2	Use extensions 220000RL	USM2002-R2      Use extensions 220000RL	
Citroën			2007..	F		28	26					USM2002-R2		USM2002-R2	
Citroën					R	14	12					USM2002-R2		USM2002-R2	
Citroën	Jumper	27/31	1994..2006	F		18.0	15.9	G	15			USM2002-R2		USM2002-R2	
Citroën		35	1994..2006	F		24.0	21.9	G	17		Use 4WD drive adapter SK-509C	USM2002-R2		USM2002-R2	
Citroën	Jumper		2006..	F		24	22.4	G	25			USM2002-R2		USM2002-R2	
Citroën					R	16	14	G	12			USM2002-R2		USM2002-R2	
Citroën	Picasso		2000..2008	F		20.4	18.4	E	3			USM2002-B3		USM2002-B3	
Citroën	C4 Picasso		2006..	F		26	24	A	None			USM2002-B3		USM2002-B3	
Citroën					R	12	10	G	20			USM2002-R2		USM2002-R2	
Citroën	C4		2010..	F		26	24	A	None			USM2002-B3		USM2002-B3	
Citroën					R	12	10	G	20			USM2002-R2		USM2002-R2	
Citroën	C5		2001..2007	F		25.5	23.5		None			USM2002-B3		USM2002-B3	
Citroën	C5		2008..	F		28	26	G	10			USM2002-R2		USM2002-R2	
Citroën					R	12	10	G	None			USM2002-R2		USM2002-R2	
Citroën	C8		2002..2014	F		28.5	26.5	G	8	SK-543		USM2002-R2	Use extensions 220000RL	USM2002-R2      Use extensions 220000RL	
Citroën					R	12.3	10.5	G	3			USM2002-R2		USM2002-R2	
Citroën	C-Crosser		2007..2012	F		24	22.4					USM2002-R2		USM2002-R2	
Citroën					R	10	8					USM2002-R2		USM2002-R2	
Daewoo	Type	Model	Year	Front	Rear	Max	Min	Drawing	Shim (mm)	QMP	Remarks	USM	Remarks	USM	Remarks
Daewoo	Damas/Labo			F		10.0	8.5	B	5			USM2002-B3		USM2002-B3	
Daewoo	Tico			F		10.0	8.5	B	5	SK-552		USM2002-B3		USM2002-B3	
Daewoo	Matiz		..2005	F		12.7	10	F	None	SK-523		USM2002-R2		USM2002-R2	
Daewoo	Racer/Cielo			F		12.7	9.7	B	12	SK-552		USM2002-B3		USM2002-B3	
Daewoo	Nexia/Cielo			F		20	18	B	10	SK-552		USM2002-B3		USM2002-B3	
Daewoo				F		24	22	B	7	SK-552		USM2002-B3		USM2002-B3	
Daewoo	Kalos		..2005	F		20	18	G	5	SK-523		USM2002-R2		USM2002-R2	
Daewoo	Lanos			F		20	18.5	B	8	SK-552		USM2002-B3		USM2002-B3	
Daewoo				F		24	22	B	7	SK-552		USM2002-B3		USM2002-B3	

Daewoo	Nubira	..2005	F		24	22	G	7	SK-523		USM2002-R2		USM2002-R2
Daewoo				R	10.4	9.0	F	None				x	Edge on mounting ear
Daewoo	Nubira	2003..2005	F		24	22	G	7	SK-523		USM2002-R2		USM2002-R2
Daewoo				R	10.5	10	G	3			USM2002-R2		USM2002-R2
Daewoo	Lacetti	2003..2005	F		24	22	G	7	SK-523		USM2002-R2		USM2002-R2
Daewoo				R	10.5	10	G	3			USM2002-R2		USM2002-R2
Daewoo	Leganza		F		24	22	G	7	SK-523		USM2002-R2		USM2002-R2
Daewoo				R	10.4	9.0	F	None			USM2002-R2		USM2002-R2
Daewoo	Evanda	2003..2005	F		24	22	G	7	SK-523		USM2002-R2		USM2002-R2
Daewoo				R	12	10	G	5			USM2002-R2		USM2002-R2
Daewoo	Espero/Aranos		F		24	22	B	7	SK-552		USM2002-B3		USM2002-B3
Daewoo	Prince		F		24	22	B	7	SK-552		USM2002-B3		USM2002-B3
Daewoo	Super salon		F		24	22	B	7	SK-552		USM2002-B3		USM2002-B3
Daewoo	Tacuma		F		24	22	G	7			USM2002-R2		USM2002-R2
Daihatsu	Type	Model	Year	Front	Rear	Max	Min	Drawing	Shim (mm)	QMP	Remarks	USM	Remarks
Daihatsu													
Daihatsu	Cuore	L201		F		16	15	D	18		Use SK-511-1 slide and SK-401	USM2002-B3	USM2002-B3
Daihatsu		L501		F		10	9	D	20		Use SK-511-1 slide and SK-401	USM2002-B3	USM2002-B3
Daihatsu		L125		F		11	9	F	None		Use SK-402	USM2002-R2	USM2002-R2
Daihatsu	Sirion	M100		F		16	15	F	None			USM2002-R2	USM2002-R2
Daihatsu	Trevis		2006..	F		16	15	F	None		Use SK-402	USM2002-R2	USM2002-R2
Daihatsu	Charade	G102		F		11	10	D	17			USM2002-B3	USM2002-B3
Daihatsu		G200		F		11	10	F	None			USM2002-R2	USM2002-R2
Daihatsu		G201		F		18	17	G	5			USM2002-R2	USM2002-R2
Daihatsu					R	9	8	G	13			USM2002-R2	USM2002-R2
Daihatsu	Valera	G203		F		18	17	G	5			USM2002-R2	USM2002-R2
Daihatsu	Applause	A101		F		18	17	D	13			USM2002-B3	USM2002-B3
Daihatsu					R	10	9	G	3		Use short uni.plates SK-532A	USM2002-R2	USM2002-R2
Daihatsu	Feroza	F300		F		12.5	11.5	G	3	SK-548	Use 4WD drive adapter SK-509C	USM2002-R2	USM2002-R2
Daihatsu	Rocky	F73, F78		F		18	17	G	3	SK-548	Use 4WD drive adapter SK-509C	USM2002-R2	USM2002-R2
Daihatsu	Rocky	F70, F75		F		12.5	11.5	F	None	SK-525	Use 4WD drive adapter SK-509C	USM2002-R2	USM2002-R2
Daihatsu		F80, F85											
Daihatsu	Hijet	S85		F		16	15	D	17		Use slide SK-511-1	USM2002-B3	USm2002-B3
Daihatsu	Grand Move			F		18	17	G	7	SK-525		USM2002-R2	USM2002-R2
Daihatsu	Materia			F								USM2002-R2	USM2002-R2



Dacia Dacia	Type	Model	Year	Front	Rear	Max	Min	Drawing	Shim (mm)	QMP	Remarks	USM	Remarks	USM	Remarks
Dacia	Sandero			F		21	19					USM2002-B3		USM2002-B3	
Dacia	Logan MCV			F		22	20					USM2002-B3		USM2002-B3	
Dacia	Lodgy		2012	F		24	22	G	18			USM2002-R2		USM2002-R2	
Dacia	Duster, Duster 4WD		2011	F		22	19	G	13			USM2002-R2		USM2002-R2	
Dacia	Dokker		2013..	F		24	22	G	18			USM2002-R2		USM2002-R2	
DFSK Dfsk	Type	Model	Year	Front	Rear	Max	Min	Drawing	Shim (mm)	QMP	Remarks	USM	Remarks	USM	Remarks
Dfsk	Loadhopper	all	2014..	F		12	10	H	3			USM2002-R2		USM2002-R2	
Dodge Dodge	Type	Model	Year	Front	Rear	Max	Min	Drawing	Shim (mm)	QMP	Remarks	USM	Remarks	USM	Remarks
Dodge	Neon	PL		F		20.0	18.4	E	13	SK-545		USM2002-B3		USM2002-B3	
Dodge				F		22.0	20.4	E	13	SK-545		USM2002-B3		USM2002-B3	
Dodge					R	9.0	7.25	E	3			USM2002-B3		USM2002-B3	
Dodge	Stratus	JA, JX		F		23.0	21.4	E	10	SK-544A		USM2002-B3		USM2002-B3	
Dodge					R	9.0		E	3			USM2002-B3		USM2002-B3	
Dodge	Magnum		2004..	F		26.5						USM2002-R2		USM2002-R2	Use extensions 220000RL
Dodge	Ram1500	pickup 4x4	1997	F		32		A	None			USM2002-B3	Use bolts M11x25 pitch1.5	USM2002-B3	Use bolts M11x25 pitch1.5
Dodge	Ram2500	pickup 4x4	1996	F		39		C	5			USM2002-B3	Use bolts M11x25 pitch1.5	USM2002-B3	Use bolts M11x25 pitch1.5
Dodge	Caravan	ES, AS		F		24.0	22.4	E	17	SK-545		USM2002-B3		USM2002-B3	
Dodge		GS, NS		F		24.0	22.4	E	15	SK-545		USM2002-B3		USM2002-B3	
Dodge		GS, NS			R	12.25	11.25	C	3			USM2002-B3		USM2002-B3	
Dodge	Ram Van	ES, AS		F		24.0	22.4	E	17	SK-545		USM2002-B3		USM2002-B3	
Dodge		GS, NS		F		24.0	22.4	E	15	SK-545		USM2002-B3		USM2002-B3	
Dodge		GS, NS			R	12.25	11.25	C	3			USM2002-B3		USM2002-B3	
Dodge	Ram Van 250	van, 5.2 ltr.	1994	F		32	30	N	3			USM2002-B3		USM2002-B3	
Dodge	Sprinter		2004	F		22	19	G	17			USM2002-R2		USM2002-R2	
Dodge					R	16	14	G	5			USM2002-R2		USM2002-R2	
Ferrari Ferrari	Type	Model	Year	Front	Rear	Max	Min	Drawing	Shim (mm)	QMP	Remarks	USM	Remarks	USM	Remarks
Ferrari	360 Modena			F		28.0		-	-	SK-587B	Use SK-587B and SK-429	Use SK-587B and SK-429. Drawing AB Use DA2002, SK-587B and SK-430. Drawing AL	Use SK-587B and SK-430. Drawing AL		
Ferrari					R	28.0		-	-	-			Use SK-587B and SK-430. Drawing AL		
Fiat Fiat	Type	Model	Year	Front	Rear	Max	Min	Drawing	Shim (mm)	QMP	Remarks	USM	Remarks	USM	Remarks
Fiat	Uno		1983..1995	F		10.8	9.0	H	3			USM2002-R2		USM2002-R2	
Fiat	Panda Twin Air		2012	F		22	20	G	12			USM2002-R2		USM2002-R2	
Fiat	Panda 4x4		2012	F		22	20	G	12			USM2002-R2		USM2002-R2	
Fiat					R	11	9.2					USM2002-R2	Consult factory workshop manual	USM2002-R2	Consult factory workshop manual

Fiat	500L		2012..	F		27						USM2002-R2		USM2002-R2	
Fiat					R	10						USM2002-R2		USM2002-R2	
Fiat	Punto	60sx	1994..	F		12.0	9.2	H	5			USM2002-R2		USM2002-R2	
Fiat		slx	2000..	F		11.0	9.2	H	3			USM2002-R2		USM2002-R2	
Fiat	Tipo		1988..1995	F		11.0	9.2	H	3			USM2002-R2		USM2002-R2	
Fiat				F		20.0	18.2	F	None			USM2002-R2	Use extensions 220000RL	USM2002-R2	Use extensions 220000RL
Fiat					R	11.0	9.2	H	3			USM2002-R2		USM2002-R2	
Fiat	Brava		1995..2001	F		12.0	10.2	H	5			USM2002-R2	Use extensions 220000RL	USM2002-R2	Use extensions 220000RL
Fiat	Tempra		1990..1998	F		11.0	9.2	H	3			USM2002-R2		USM2002-R2	
Fiat				F		20.0	18.2	F	None			USM2002-R2		USM2002-R2	
Fiat					R	11.0	9.2	H	3			USM2002-R2		USM2002-R2	
Fiat	Marea		1996..2007	F		20	18.2					USM2002-R2		USM2002-R2	
Fiat	Ulysse	121	1994..2002	F		26.0	24.2	G	8	SK-543		USM2002-R2	Use extensions 220000RL	USM2002-R2	Use extensions 220000RL
Fiat	Ulysse		2003..2014	F		28.5	26.5	G	8	SK-543		USM2002-R2	Use extensions 220000RL	USM2002-R2	Use extensions 220000RL
Fiat					R	12.3	10.5	G	3			USM2002-R2		USM2002-R2	
Fiat	Fiorino		2008..	F		22	20	G	10			USM2002-R2		USM2002-R2	
Fiat	Doblo		..2010	F		22	20	G	10			USM2002-R2		USM2002-R2	
Fiat			2010..	F		28	26					USM2002-R2	Use extensions 220000RL	USM2002-R2	Use extensions 220000RL
Fiat	Scudo		1996..2007	F		20.4	18.2	G	10	SK-543		USM2002-R2	Use extensions 220000RL	USM2002-R2	Use extensions 220000RL
Fiat			2007..	F		28	26					USM2002-R2		USM2002-R2	
Fiat					R	14	12					USM2002-R2		USM2002-R2	
Fiat	Ducato	10 14	1994..2006	F		18.0	15.9	G	15			USM2002-R2		USM2002-R2	
Fiat		18	1994..2006	F		24.0	21.9	G	17	Use 4WD drive adapter SK-509C		USM2002-R2	Use 4WD drive adapter SK-509C	USM2002-R2	Use 4WD drive adapter SK-509C
Fiat	Ducato		2006..	F		24	22.4	G	25			USM2002-R2		USM2002-R2	
Fiat					R	16	14	G	12			USM2002-R2		USM2002-R2	
Ford Europa	Type	Model	Year	Front	Rear	Max	Min	Drawing	Shim (mm)	QMP	Remarks	USM	Remarks	USM	Remarks
Ford Europa															
Ford Europa	Ecosport	Ø280x25	2014..	F		25.0	23.0					USM2002-R2		USM2002-R2	
Ford Europa	B-Max		2013..	F		23.0	21.0	G	7			USM2002-R2		USM2002-R2	
Ford Europa	Ka			F		12.0	10.0	F	None	SK-512B		USM2002-R2		USM2002-R2	
Ford Europa	Fiesta			F		10.0	8.0	G	3	SK-512B		USM2002-R2		USM2002-R2	
Ford Europa				F		12.0	10.0	G	3	SK-512B		USM2002-R2		USM2002-R2	
Ford Europa				F		20.0	18.0	G	7	SK-512B		USM2002-R2		USM2002-R2	
Ford Europa			2002..2008	F		22.0	20.0	G	7	SK-512B		USM2002-R2		USM2002-R2	
Ford Europa			2008..	F		24.0	22.0	G	7	SK-512B		USM2002-R2		USM2002-R2	
Ford Europa	Escort			F		10.0	8.0	G	3	SK-512B		USM2002-R2		USM2002-R2	
Ford Europa				F		20.0	18.0	G	7	SK-512B		USM2002-R2		USM2002-R2	
Ford Europa				F		24.0	22.0	G	7	SK-512B		USM2002-R2		USM2002-R2	

Ford Europa	Focus			F		22.0	20.0	C	10		Use M9 bolts SK-411 on caliper	Use M9 bolts SK-411 on caliper	USM2002-B3	Use M9 bolts SK-411 on caliper	
Ford Europa					R	10.0	8.9	F	None			USM2002-R2	USM2002-R2		
Ford Europa			2011..	F		25.0	23.0	G	12			USM2002-R2	USM2002-R2		
Ford Europa	Kuga	Ø300x25	2013..	F		25.0	23.0					USM2002-R2	USM2002-R2		
Ford Europa		Ø280x11			R	11.0	9.0					USM2002-R2	USM2002-R2		
Ford Europa	S-Max		2006..	F		28.0	26.0	G	13			USM2002-R2	USM2002-R2		
Ford Europa					R	11.0	9.0	G	15			USM2002-R2	USM2002-R2		
Ford Europa	Sierra			F		24.0	22.2	G	7	SK-512B		USM2002-R2	USM2002-R2		
Ford Europa	P100			F		24.0	22.2	G	7	SK-512B		USM2002-R2	USM2002-R2		
Ford Europa	Mondeo		1994..2001	F		24.0	22.2	G	7	SK-512B		USM2002-R2	USM2002-R2		
Ford Europa					R	20.0	18.0	G	25	SK-512B		USM2002-R2	USM2002-R2		
Ford Europa			2001..2008	F		24.0	22.2	G	7	SK-512B		USM2002-R2	USM2002-R2		
Ford Europa					R	12.0	10.0	G	22	SK-512B		USM2002-R2	USM2002-R2		
Ford Europa			2008..2015	F		28.0	26.0	G	13			USM2002-R2	USM2002-R2		
Ford Europa					R	11.0	9.0	G	15			USM2002-R2	USM2002-R2		
Ford Europa			2015..	F		26.5		G	13			USM2002-R2	USM2002-R2		
Ford Europa					R	11.0		G	15			USM2002-R2	USM2002-R2		
Ford Europa	Scorpio			F		24.0	22.2	G	7	SK-512B		USM2002-R2	USM2002-R2		
Ford Europa					R	20.0	18.0	G	10	SK-512B		USM2002-R2	USM2002-R2		
Ford Europa					R	10.0	8.0	G	13	SK-512B		USM2002-R2	USM2002-R2		
Ford Europa	Probe			F		24.0	22.0	G	7	SK-534		USM2002-R2	USM2002-R2		
Ford Europa					R	10.0	8.0	G	17	SK-517B		USM2002-R2	USM2002-R2		
Ford Europa	Maverick			F		26.0	24.0	G	18	SK-517B	Use 4WD drive adapter SK-509C	USM2002-R2	Use 4WD drive adapter SK-509C	Use 4WD drive adapter SK-509C	
Ford Europa	Galaxy			F		25.0	23.0	N	5			USM2002-R2	USM2002-R2		
Ford Europa					R	10.0	8.0	F	None			USM2002-R2	USM2002-R2		
Ford Europa			2007..	F		28.0	26.0					USM2002-R2	USM2002-R2		
Ford Europa					R	11.0	9.0					USM2002-R2	USM2002-R2		
Ford Europa	Transit			F		14.3	12.15	G	None	Use USM		USM2002-R2	USM2002-R2	Loosen bottom bolts of shockabsorber 5 mm	
Ford Europa	Transit Connect			F		24.2	22.2	G	5	SK-512B		USM2002-R2	USM2002-R2		
Ford Europa	Transit 350		2000..	F		24.3	22.3	G	17			USM2002-R2	USM2002-R2		
Ford Europa	Transit Custom		2013..	F		33.0		R	8			USM2002-R2	Use DL8702 or DL8704	USM2002-R2	
Ford Europa					R	16.0		G	13			USM2002-R2	Use DL8702 or DL8704	USM2002-R2	
Ford U.S.A.	Type	Model	Year	Front	Rear	Max	Min	Drawing	Shim (mm)	QMP	Remarks	USM	Remarks	USM	Remarks
Ford U.S.A.															
Ford U.S.A.	Explorer		1994	F		24.9	20.6	-	-	SK-505	Use 4WD drive adapter SK-509C	USM2002-R2	Use 4WD drive adapter SK-509C	USM2002-R2	Use 4WD drive adapter SK-509C
Ford U.S.A.	Explorer Sport Trac		2000	F		26	24.5	G	8			USM2002-R2		USM2002-R2	

Ford U.S.A.	Bronco			F	30.2	28.5	-	-	SK-505	Use 4WD drive adapter SK-509C	USM2002-R2	Use 4WD drive adapter SK-509C	USM2002-R2	Use 4WD drive adapter SK-509C	
Ford U.S.A.	Bronco II			F	24.9	20.6	-	-	SK-505	Use 4WD drive adapter SK-509C	USM2002-R2	Use 4WD drive adapter SK-509C	USM2002-R2	Use 4WD drive adapter SK-509C	
Ford U.S.A.	Ranger			F	24.9	20.6	-	-	SK-505	Use 4WD drive adapter SK-509C	USM2002-R2	Use 4WD drive adapter SK-509C	USM2002-R2	Use 4WD drive adapter SK-509C	
			2011	F	28	25.5	G	10		Use 4WD drive adapter SK-509C	USM2002-R2	Use 4WD drive adapter SK-509C	USM2002-R2	Use 4WD drive adapter SK-509C	
			2013	F	32	30	L	None			USM2002-R2	Use extensions 220000RL	USM2002-R2		
Ford U.S.A.	Aerostar			F	24.9	20.6	-	-	SK-505	Use 4WD drive adapter SK-509C	USM2002-R2	Use 4WD drive adapter SK-509C		Use 4WD drive adapter SK-509C	
Ford U.S.A.	E-150		2000	F	26	24.5	C	15			C		Use universal blue plates and shim 12		
Ford U.S.A.	F-150		1996	F	26	24.5	C	15			C		Use universal blue plates and shim 12		
Ford U.S.A.	F-150		2001	F	26	24.5	G	15			USM2002-R2		USM2002-R2		
Ford U.S.A.	F-150	Ø350	2015..	F	34	32					USM2002-R2	Use extensions 220000RL	USM2002-R2	Use extension 220000RL on the bottom or top mounting	
Ford U.S.A.	Ø347				R	25	23				USM2002-R2		USM2002-R2	Use extension 220000RL on the bottom mounting	
Ford U.S.A.	F-250		1997	F	30	28.5	-	-		Use 4WD drive adapter SK-509C	USM2002-R2	Use extensions 220000RL and 4WD drive adapter SK-509C	USM2002-R2	Use extensions 220000RL and 4WD drive adapter SK-509C	
Ford U.S.A.	F-250	Super Duty	2004	F	38	36							USM2002-R2	Use extensions 220000RL	
Ford U.S.A.	F-350	Super Duty	1999	F	38	36							USM2002-R2	Use extensions 220000RL	
Freightliner	Type	Model	Year	Front	Rear	Max	Min	Drawing	Shim (mm)	QMP	Remarks	USM	Remarks	USM	Remarks
Freightliner	Sprinter			2002	F	22	19	G	17			USM2002-R2		USM2002-R2	
Freightliner					R	16	14	G	5			USM2002-R2		USM2002-R2	
FSO	Type	Model	Year	Front	Rear	Max	Min	Drawing	Shim (mm)	QMP	Remarks	USM	Remarks	USM	Remarks
FSO															
FSO	Prima		93..	F	10	9	H	3				USM2002-R2		USM2002-R2	
FSO					R	10	9	H	5			USM2002-R2		USM2002-R2	
Galloper	Type	Model	Year	Front	Rear	Max	Min	Drawing	Shim (mm)	QMP	Remarks	USM	Remarks	USM	Remarks
Galloper															
Galloper	Galloper		99..	F	22	20	G	10	SK-527A			USM2002-R2		USM2002-R2	
GMC	Type	Model	Year	Front	Rear	Max	Min	Drawing	Shim (mm)	QMP	Remarks	USM	Remarks	USM	Remarks
GMC															
GMC	Jimmy		98..	F	29.2			K	None		Use SK-407 bolts	USM2002-R2		USM2002-R2	
GMC	Envoy		2003	F	29			G	20			USM2002-R2		USM2002-R2	

GMC	Yukon		2003	F	29							USM2002-R2	Use extensions 220000RL	USM2002-R2	
GMC	Yukon Denali		2003	F	29							USM2002-R2	Use extensions 220000RL	USM2002-R2	
Holden	Type	Model	Year	Front	Rear	Max	Min	Drawing	Shim (mm)	QMP	Remarks	USM	Remarks	USM	Remarks
Holden	Barina	B		F		12.7	9.7	B	13	SK-535		USM2002-B3		USM2002-B3	
Holden				F		20	17	D	8			USM2002-B3		USM2002-B3	
Holden	Astra	G		F		20	17	B	10	SK-535		USM2002-B3		USM2002-B3	
Holden				F		24	21	C	8		Use M9 bolts SK-411 on caliper	C	Use M9 bolts SK-411 on caliper	USM2002-B3	Use M9 bolts SK-411 on caliper
Holden				F		25	22	B	7			USM2002-B3		USM2002-B3	
Holden					R	10	8	G	17			USM2002-R2		USM2002-R2	
Holden	Vectra	A		F		12.7	10.7	B	13	SK-535		USM2002-B3		USM2002-B3	
Holden				F		20	17	B	10	SK-535		USM2002-B3		USM2002-B3	
Holden		B		F		24	21	B	7	SK-535		USM2002-B3		USM2002-B3	
Holden					R	10	8	B	12			USM2002-B3		USM2002-B3	
Holden	Zafira			F		25	22	D	7			USM2002-B3		USM2002-B3	
Holden	Frontera			F		22	20.6	G	10	SK-542	Use slide SK-511-1	USM2002-R2	Use DL8702 or SK-511-1	USM2002-R2	
Holden				F		26	24.6	G	10	SK-542		USM2002-R2		USM2002-R2	
Holden					R	18	16.6	G	7			USM2002-R2		USM2002-R2	
Holden	Jackaroo			F		26	24.6	G	10	SK-542		USM2002-R2		USM2002-R2	
Holden					R	18	16.6	G	7			USM2002-R2		USM2002-R2	
Honda	Type	Model	Year	Front	Rear	Max	Min	Drawing	Shim (mm)	QMP	Remarks	USM	Remarks	USM	Remarks
Honda	Logo	GA		F		21	19	G	3	SK-521B		USM2002-R2		USM2002-R2	
Honda	Jazz	GD1		F		21	19	G	3	SK-521B		USM2002-R2		USM2002-R2	
Honda	Jazz (Hybrid)	GP1	2014	F		21	19					USM2002-R2		USM2002-R2	
Honda					R	10	8					USM2002-R2		USM2002-R2	
Honda	Civic	EH		F		17	15	G	3	SK-521B		USM2002-R2		USM2002-R2	
Honda		EG, EJ		F		21	19	G	3	SK-521B		USM2002-R2		USM2002-R2	
Honda		MA, MB		F		21	19	G	5	SK-521B		USM2002-R2		USM2002-R2	
Honda	Civic shuttle	EE		F		19	17	G	3	SK-521B		USM2002-R2		USM2002-R2	
Honda	Civic	EP, EU		F		21	19	G	7	SK-521B		USM2002-R2		USM2002-R2	
Honda				F		23	21	G	7	SK-521B		USM2002-R2		USM2002-R2	
Honda				F		25	23	G	5	SK-521B		USM2002-R2		USM2002-R2	
Honda					R	9	8	F	None			USM2002-R2		USM2002-R2	
Honda					R	10	8	F	None			USM2002-R2		USM2002-R2	
Honda			2006	F		23	21	G	5	SK-521B		USM2002-R2		USM2002-R2	
Honda					R	9	7.5	F	None		Use short uni.plates SK-532A	USM2002-R2		USM2002-R2	
Honda	Insight	ZE1		F		17	15	F	None	SK-521B		USM2002-R2		USM2002-R2	
Honda	Concerto	HW		F		19	17	G	5	SK-521B		USM2002-R2		USM2002-R2	

Honda	CRX	ED, EE		F	19	17	G	3	SK-521B		USM2002-R2		USM2002-R2	
Honda	CRX		2001	F							USM2002-R2	Use extensions 220000RL	USM2002-R2	Use extensions 220000RL
Honda	Prelude	BA		F	19	17	G	5	SK-521B		USM2002-R2		USM2002-R2	
Honda		BB		F	23	21	G	5	SK-521B		USM2002-R2		USM2002-R2	
Honda					R	10	8	G	3	Use short uni.plates SK-532A	USM2002-R2		USM2002-R2	
Honda	Accord	CB, CG		F	23	21	G	5	SK-521B		USM2002-R2		USM2002-R2	
Honda	Accord Aerodeck	CB8		F	23	21	G	5	SK-521B		USM2002-R2		USM2002-R2	
Honda	Accord	CG9		F	25	23	G	5	SK-521B		USM2002-R2		USM2002-R2	
Honda					R	10	8	G	7		USM2002-R2	Use shim-7mm [8740114]	USM2002-R2	Use shim-7mm [8740114]
Honda	Accord type R	CH		F	28	26	G	5	SK-521B		USM2002-R2		USM2002-R2	
Honda					R	10	8	G	3	Use short uni.plates SK-532A	G		x	
Honda	Accord	CL7, CL9		F	25	23	G	7	SK-521B		USM2002-R2		USM2002-R2	
Honda					R	10	8	M	12		USM2002-R2		USM2002-R2	
Honda	Accord Tourer	CM1, CM2		F	25	23	G	7	SK-521B		USM2002-R2		USM2002-R2	
Honda					R	9	7.5	M	12		USM2002-R2		USM2002-R2	
Honda	Accord Tourer	CW2	2008..	F	32	30					USM2002-R2	Use extensions 220000RL	USM2002-R2	
Honda					R	9	7.5				USM2002-R2		USM2002-R2	
Honda	Integra type R	DC		F	23	21	G	8	SK-521B		USM2002-R2		USM2002-R2	
Honda					R	9	8	G	3	Use short uni.plates SK-532A	USM2002-R2		USM2002-R2	
Honda	Stream	RN1		F	21	19	G	5	SK-521B		USM2002-R2		USM2002-R2	
Honda		RN3		F	23	21	G	5	SK-521B		USM2002-R2		USM2002-R2	
Honda		RN1, RN3			R	12	10	M	12		USM2002-R2		USM2002-R2	
Honda	Legend	KA		F	23	21	G	5	SK-521B					
Honda				F	28	26	G	5	SK-521B		USM2002-R2		USM2002-R2	
Honda					R	9.5	7.5	M	12		USM2002-R2		USM2002-R2	
Honda	Legend	KB1	2005	F							USM2002-R2	Use SK-572 with USM	USM2002-R2	Use SK-572 with USM
Honda					R						USM2002-R2		USM2002-R2	
Honda	S2000	AP1		F	25	23	G	5			USM2002-R2		USM2002-R2	
Honda					R	12	10	G	3		USM2002-R2		USM2002-R2	
Honda	CR-V	RD1, RD8	1995..2006	F	23	21	G	5	SK-521B		USM2002-R2		USM2002-R2	
Honda					R	9	7	M	12		USM2002-R2		USM2002-R2	
Honda		RE	2006..2012	F	28	26	G	10	SK-521B		USM2002-R2		USM2002-R2	
Honda					R	10	8		Use USM ->		USM2002-R2		USM2002-R2	
Honda		RM	2012..	F	28	26	G	10			USM2002-R2		USM2002-R2	
Honda					R	10	8		Use USM ->		USM2002-R2		USM2002-R2	
Honda	Element		2003	F	23	21	G	5	SK-521B		USM2002-R2		USM2002-R2	

Honda				R	9	7.5	M	12				USM2002-R2	USM2002-R2			
Honda	HR-V	GH2, GH4		F	23	21	G	5	SK-521B			USM2002-R2	USM2002-R2			
Honda	Shuttle	RA		F	23	21	G	7	SK-521B			USM2002-R2	USM2002-R2			
Honda	MDX	2003		F								USM2002-R2	USM2002-R2			
Honda				R								USM2002-R2	Use extensions 220000RL	USM2002-R2	Use extensions 220000RL	
Honda	Passport	2000		F	26	24.6	G	10	SK-542			USM2002-R2	USM2002-R2			
Honda				R	18	16.6	G	7				USM2002-R2	USM2002-R2			
Honda	Pilot	2003		F	28	26						USM2002-R2	USM2002-R2			
Honda				R	11	9						USM2002-R2	USM2002-R2			
Hummer	Type	Model	Year	Front	Rear	Max	Min	Drawing	Shim (mm)	QMP	Remarks	USM	Remarks	USM	Remarks	
Hummer	H2		2003	F								USM2002-R2	Use extensions 220000RL	USM2002-R2		
Hyundai	Type	Model	Year	Front	Rear	Max	Min	Drawing	Shim (mm)	QMP	Remarks	USM	Remarks	USM	Remarks	
Hyundai	i10		2012..	F		18	16	G	7			USM2002-R2		USM2002-R2		
Hyundai	i20			F		18	16					USM2002-R2	USM2002-R2			
Hyundai	Pony			F		19	17	G	3	SK-527A		USM2002-R2	USM2002-R2			
Hyundai	Atos			F		11	9.4	G	3			USM2002-R2	USM2002-R2			
Hyundai	Excel / Accent			F		19	17	F	None	SK-527A		USM2002-R2	USM2002-R2			
Hyundai	Getz			F		19	17	F	None	SK-527A		USM2002-R2	USM2002-R2			
Hyundai	Matrix			F		24	22.4	G	7	SK-527A		USM2002-R2	USM2002-R2			
Hyundai	Scoupe			F		19	17	G	3	SK-527A		USM2002-R2	USM2002-R2			
Hyundai	Coupe	RD	1996..2002	F		22	20	G	7	SK-527A		USM2002-R2	USM2002-R2			
Hyundai				R		10	8	-	-		Use DA2002 with Universal Red Plates, shims 3 and 7 mm.	Use DA2002 with Universal Red Plates, shims 3 and 7 mm.		Use DA2002 with Universal Red Plates, shims 3 and 7 mm.		
Hyundai	Lantra			F		19	17	G	8	SK-527A		USM2002-R2	USM2002-R2			
Hyundai				F		21	19	G	8			USM2002-R2	USM2002-R2			
Hyundai				F		22	20	G	8	SK-527A		USM2002-R2	USM2002-R2			
Hyundai				F		26	24	G	7			USM2002-R2	Use extensions 220000RL	USM2002-R2		
Hyundai				R		10	8.4	G	7			G		SK-532A-1 with SK-422		
Hyundai	iX20	Ø280x26	2014..	F		26	24.4								USM2002-R2	USM2002-R2
Hyundai					R	10	8.4						SK-532A-1 with SK-421	USM2002-R2		
Hyundai				iX35		2010..	F		28	26			USM2002-R2	USM2002-R2		
Hyundai					R	10	8.4						USM2002-R2	USM2002-R2		
Hyundai				Veloster		2011..	F		23	21			USM2002-R2	USM2002-R2		
Hyundai					R	10	8.4						USM2002-R2	USM2002-R2		
Hyundai				Santa Fé		F	26.1	24.4	G	7	SK-527A		USM2002-R2	USM2002-R2		
Hyundai	Santa Fé		2006..	F		28	26	G	10			USM2002-R2	Use extensions 220000RL	USM2002-R2		

Hyundai				R	11	9.4	F	None				USM2002-R2	Use extensions 220000RL	USM2002-R2	Use extensions 220000RL
Hyundai	Sonata			F		22	20	G	8	SK-527A		USM2002-R2		USM2002-R2	
Hyundai				F		24	22.4	G	8	SK-527A		USM2002-R2		USM2002-R2	
Hyundai				R	10	8.4	G	5				USM2002-R2		USM2002-R2	
Hyundai	Trajet			F		26	24	G	8			USM2002-R2		USM2002-R2	
Hyundai				R	10	8.4	G	7				USM2002-R2		USM2002-R2	
Hyundai	Terracan			F		27	25	G	8		Use 4WD drive adapter SK-509C	USM2002-R2		USM2002-R2	
Hyundai				R	20	18	G	5		Use 4WD drive adapter SK-509C		USM2002-R2		USM2002-R2	
Hyundai	Tucson	2004..2015		F		26	24.4							USM2002-R2	Use extensions 220000RL
Hyundai				R	10	8								USM2002-R2	
Hyundai	Tucson	Ø305x25	2015..	F		25	23					USM2002-R2	Use extensions 220000RL	USM2002-R2	Use extensions 220000RL
Hyundai		Ø400x10		R	10	8						USM2002-R2		USM2002-R2	
Hyundai	H100			F		20	18	G	13			USM2002-R2		USM2002-R2	
Hyundai	H200			F		24	22.4	G	10	SK-551		USM2002-R2		USM2002-R2	
Hyundai	H300	2008		F		30						USM2002-R2		USM2002-R2	
Hyundai				R	20							USM2002-R2		USM2002-R2	
Infiniti	Type	Model	Year	Front	Rear	Max	Min	Drawing	Shim (mm)	QMP	Remarks	USM	Remarks	USM	Remarks
Infiniti	Q45T	Ø295	1993..2000	F		27	25	G	15			USM2002-R2		USM2002-R2	
Infiniti		Ø292			R	16	14	G	7		Left: use Universal Red Plates. Right: Use USM 2002- R1	USM2002-R2	Left: use Universal Red Plates.	USM2002-R2	Put handle DL2002 on top at both sides
Infiniti	G37 Coupé, G37 GT Coupé	Ø320	2008..	F		34	32	-				USM2002-R2	Use extensions 220000RL	USM2002-R2	
Infiniti		Ø308			R	16	14	-				x		USM2002-R2	Use extension 220000RL on the bottom mounting
Infiniti	G37S Coupé	Ø355	2008..	F		32	30	-				USM2002-R2	Use extensions 220000RL	USM2002-R2	Use extensions 220000RL
Infiniti		Ø350			R	20	18	-				x		USM2002-R2	Use extension 220000RL on the bottom mounting
Infiniti	G37, G37GT	Ø320	2008..	F		34	32	-				USM2002-R2	Use extensions 220000RL	USM2002-R2	
Infiniti		Ø308			R	16	14	-				x		USM2002-R2	Use extension 220000RL on the bottom mounting
Infiniti	G37S	Ø355	2008..	F		32	30	-				USM2002-R2	Use extensions 220000RL	USM2002-R2	Use extensions 220000RL
Infiniti		Ø350			R	20	18	-				x		USM2002-R2	Use extension 220000RL on the bottom mounting
Infiniti	EX37, EX37GT	Ø320	2008..	F		34	32	-				USM2002-R2	Use extensions 220000RL	USM2002-R2	



Infiniti		Ø308			R	16	14	-				USM2002-R2	Use extension 220000RL on the bottom mounting	USM2002-R2	Use extension 220000RL on the bottom mounting
Infiniti	FX37GT, FX37S, FX50S	Ø355	2008..	F		32	30	-				USM2002-R2	Use extensions 220000RL	USM2002-R2	Use extensions 220000RL
Infiniti		Ø350			R	20	18	-				USM2002-R2	Use extension 220000RL on the bottom mounting	USM2002-R2	Use extension 220000RL on the bottom mounting
Isuzu	Type	Model	Year	Front	Rear	Max	Min	Drawing	Shim (mm)	QMP	Remarks	USM	Remarks	USM	Remarks
Isuzu	Rodeo		2000	F		26	24.6	G	10	SK-542		USM2002-R2		USM2002-R2	
Isuzu					R	18	16.6	G	7			USM2002-R2		USM2002-R2	
Isuzu	D-Max	Ø280	2002..2012	F		27		G	10			USM2002-R2		USM2002-R2	
Isuzu		Ø300	2012..	F		27						USM2002-R2		USM2002-R2	
Iveco	Type	Model	Year	Front	Rear	Max	Min	Drawing	Shim (mm)	QMP	Remarks	USM	Remarks	USM	Remarks
Iveco	Daily	35S11	2000	F		22	19	G	17			USM2002-R2	Use extensions 220000RL	USM2002-R2	
Iveco					R	16	13	G	15			USM2002-R2		USM2002-R2	
Jaguar	Type	Model	Year	Front	Rear	Max	Min	Drawing	Shim (mm)	QMP	Remarks	USM	Remarks	USM	Remarks
Jaguar	Mk2	3.8	1959..1967	F		18	16					USM2002-B3		USM2002-B3	
Jaguar					R	9.5	8.5					USM2002-B3		USM2002-B3	
Jaguar	XJ40			F		28.5	26.0	G	7	SK-558		USM2002-R2		USM2002-R2	
Jaguar					R	20.0	18.5	G	3			USM2002-R2		USM2002-R2	
Jaguar	XJ6 chassis# >720001			F		28.5	26.0	G	7	SK-558		USM2002-R2		USM2002-R2	
Jaguar					R	20.0	18.5	G	3			USM2002-R2		USM2002-R2	
Jaguar	X-type	X400		F		24.0	22.0	G	7	SK-558		USM2002-R2		USM2002-R2	
Jaguar					R	12.0	10.0	G	22			USM2002-R2		USM2002-R2	
Jaguar	S Type	X200		F		30.0	28.0	R				USM2002-R2	Use extensions 220000RL	USM2002-R2	Use extensions 220000RL
Jaguar					R	20.0	18.5	G	17	SK-532		G	No space	USM2002-R2	
Jaguar	XKR	X100		F		28.5	26.0	G	8	SK-547		USM2002-R2		USM2002-R2	
Jaguar					R	20.0	18.5	G	3			USM2002-R2		USM2002-R2	
Jaguar	XJ V8	X308		F		28.5	26.0	G	8	SK-547		USM2002-R2		USM2002-R2	
Jaguar					R	20.0	18.5	G	3			USM2002-R2		USM2002-R2	
Jaguar	XJR	X300		F								USM2002-B3	Use extensions 220000BL	USM2002-B3	Use extensions 220000BL
Jaguar					R							USM2002-R2	Use extension 220000RL on the bottom mounting	USM2002-R2	Use extension 220000RL on the bottom mounting
Jaguar	XJ8	X350		F		30.0	28.0	G	11			USM2002-R2		USM2002-R2	
Jaguar					R	20.0	18.0	G	17		Use SK-532 on top mount	G		USM2002-R2	
Jaguar	XJR	X350		F		32.0	30.0	P	12		Use UP-BL1	USM2002-B3	Use extensions 220000BL	USM2002-B3	Use extensions 220000BL

Jaguar					R	15.0	13.0	B	3		Use parking brake attachment	USM2002-R2	Use extension 220000RL on the bottom mounting	USM2002-R2	Use extension 220000RL on the bottom mounting
Jaguar	XF 2.2 / 3.0	X250	2009..	F		30.0	28.0	G	10			USM2002-R2		USM2002-R2	
Jaguar					R	20.0	18.0	G	12		Use SK-532 on top mount	G	Use SK-532 on top mount	USM2002-R2	Use extension 220000RL on the bottom mounting
Jaguar	XFR	X250	2009..	F		36.0	34.0	L	None			USM2002-R2	Use extensions 220000RL	USM2002-R2	Use extensions 220000RL
Jaguar					R	26.0	24.0	-				-		USM2002-R2	Use extension 220000RL on the bottom mounting
Jeep	Type	Model	Year	Front	Rear	Max	Min	Drawing	Shim (mm)	QMP	Remarks	USM	Remarks	USM	Remarks
Jeep	Wrangler	YJ		F		24.0	22.7	E	10	SK-544A		USM2002-B3		USM2002-B3	
Jeep		JK		F		28.0	26.0	G	13			USM2002-R2		USM2002-R2	
Jeep					R	12.0	10.0	B	10			USM2002-B3	Turn bow	USM2002-B3	Turn bow
Jeep	Cherokee	XJ		F		24.0	22.7	E	10	SK-544A		USM2002-B3		USM2002-B3	
Jeep	Cherokee	KJ		F		28.0	26.0	G	13			USM2002-R2		USM2002-R2	
Jeep	Grand Cherokee	ZJ, ZG		F		24.0	22.7	E	10	SK-544A		USM2002-B3		USM2002-B3	
Jeep					R	11.0	9.5	E	5			USM2002-B3		USM2002-B3	
Jeep	Grand Cherokee	WJ		F		26.0	24.5	G	8	SK-568		USM2002-R2	Use extensions 220000RL	USM2002-R2	
Jeep					R	10.0	8.5	B	5			USM2002-B3		USM2002-B3	
Jeep		WK		F		30.0	28.0				Use USM	USM2002-R2	Use (one) extension 220000RL	USM2002-R2	
Jeep					R	13.5	12.5	A	7			A	Use universal blue with shim 7	A	Use universal blue with shim 5
Kia	Type	Model	Year	Front	Rear	Max	Min	Drawing	Shim (mm)	QMP	Remarks	USM	Remarks	USM	Remarks
Kia	Soul		2009..	F		26	24					USM2002-R2		USM2002-R2	
Kia					R	10	8					USM2002-R2		USM2002-R2	
Kia	Pride			F		13	11	B	15		Use small silencer SK-402	USM2002-B3		USM2002-B3	
Kia	Rio			F		22	20	D	12			USM2002-B3		USM2002-B3	
Kia	Rio		2002..2006	F				G	5			USM2002-R2		USM2002-R2	
Kia	Rio		2006..	F		22	20	G	7			USM2002-R2		USM2002-R2	
Kia					R	10		G	5		Use short uni.plates SK-532A	Use short uni.plates SK-532		USM2002-R2	
Kia	Sephia			F		20	18	G	3	SK-542		USM2002-R2		USM2002-R2	
Kia	Cerato			F		26	24	G	5			USM2002-R2	Use extensions 220000RL	USM2002-R2	
Kia					R	10	8	-	-			x		x	
Kia	Shuma			F		20	18	G	5	SK-542		USM2002-R2		USM2002-R2	
Kia	Shuma II			F				G	5			USM2002-R2		USM2002-R2	

Kia				R				G	17		Use short uni.plates SK-532A	USM2002-R2		Prefer to use SK-532	USM2002-R2				
Kia	Credos / Clarus			F	24	22	G	5	SK-537B			USM2002-R2		USM2002-R2					
Kia				R	10	8	G	18		SK-519C		USM2002-R2		USM2002-R2					
Kia	Magentis / Optima			F								USM2002-R2		USM2002-R2					
Kia				R								USM2002-R2		USM2002-R2					
Kia	Magentis	2006..	F	26	24	G	8					USM2002-R2		USM2002-R2					
Kia				R	10	8.4			SK-546		Use SK-546	USM2002-R2		Use extension 220000RL on the bottom mounting	USM2002-R2		Use extension 220000RL on the bottom mounting		
Kia	Opirus		F	28		G	3		Use UP-RL1			USM2002-R2		Use extensions 220000RL	USM2002-R2		Use extensions 220000RL		
Kia	Opirus		R						None					USM2002-R2		USM2002-R2			
Kia	Carens	.. 2006	F	26	24	G	7					USM2002-R2		USM2002-R2					
Kia				R	10	8	G	18					USM2002-R2		USM2002-R2				
Kia	Carens	2006 ..	F	26	24	G	7					USM2002-R2		USM2002-R2					
Kia				R	10	8.4	-	-		SK-546		Use SK-546	USM2002-R2		Use extension 220000RL on the bottom mounting	USM2002-R2		Use extension 220000RL on the bottom mounting	
Kia	Joice		F	23	21	G						USM2002-R2		USM2002-R2					
Kia	Carnival		F	24	22	C	10					USM2002-B3		USM2002-B3					
Kia	Carnival	2000..2006	F			G	7					USM2002-R2		Use extensions 220000RL	USM2002-R2				
Kia	Carnival	2006..	F	28	26	G	10		SK-518A					USM2002-R2		USM2002-R2			
Kia				R	12	10.4	G	13					USM2002-R2		Disconnect bottom bolt shockabsorber	USM2002-R2		Disconnect bottom bolt shockabsorber	
Kia				Sportage II	2005	F	26	24.4							USM2002-R2		Use extensions 220000RL		
Kia				R	10	8									USM2002-R2				
Kia	Sportage		F	24.0	22.5	G	8		SK-542					USM2002-R2		USM2002-R2			
Kia	Sorento Ex		F	28.1	26	G	8					USM2002-R2		USM2002-R2					
Kia				R	20	18.4	G	5		SK-518A					USM2002-R2		USM2002-R2		
Kia	Pregio		F	26.2	24	G						USM2002-R2		Use extensions 220000RL	USM2002-R2				
Kia	Besta		F	20.0	18.0	G	7				Use slide SK-511-1	USM2002-R2		USM2002-R2					
Kia	K2700		F	24.2	22	G	8				Use slide SK-511-1	USM2002-R2		Use extensions 220000RL	USM2002-R2				
Lada	Type	Model	Year	Front	Rear	Max	Min	Drawing	Shim (mm)	QMP	Remarks	USM		Remarks	USM		Remarks		
Lada	111			F	20.0	18.0	G	12					USM2002-R2		USM2002-R2				
Lada	Niva	2121	77..	F	11.0	9.9						USM2002-R2		Use extensions 220000RL	USM2002-R2		Use extensions 220000RL		
Lamborghini	Type	Model	Year	Front	Rear	Max	Min	Drawing	Shim (mm)	QMP	Remarks	USM		Remarks	USM		Remarks		
Lamborghini	Murciélago	2001..	F	32	-						Use SK-587B		Use SK-587B		Use SK-587B				

Lamborghini				R	32	-		Use modified SK-587B				Use modified SK-587B		Use modified SK-587B	
Lancia	Type	Model	Year	Front	Rear	Max	Min	Drawing	Shim (mm)	QMP	Remarks	USM	Remarks	USM	Remarks
Lancia															
Lancia	Y10 touring			F		10.8	9.0	H	3		Use caliper spacer SK-401	USM2002-R2		USM2002-R2	
Lancia	Delta 1.8			F		12.0	10.2	H	3			USM2002-R2	Use extensions 220000RL	USM2002-R2	Use extensions 220000RL
Lancia					R	11.0	9.2	H	3			USM2002-R2		USM2002-R2	
Lancia	Delta	Integrale 8v/16v	88..91	F		22.1	20.2					USM2002-R2	Use extensions 220000RL	USM2002-R2	Use extensions 220000RL
Lancia					R	10.9	9							USM2002-R2	Use extension 220000RL on the bottom mounting
Lancia	Dedra 1.8			F		12.0	10.2	H	3			USM2002-R2	Use extensions 220000RL	USM2002-R2	Use extensions 220000RL
Lancia					R	11.0	9.2	H	3			USM2002-R2		USM2002-R2	
Lancia	Thema 2.0			F		20.0	18.2	F	None			USM2002-R2		USM2002-R2	
Lancia	Zeta			F		26.0	24.2	G	8	SK-543		USM2002-R2	Use extensions 220000RL	USM2002-R2	Use extensions 220000RL
Lancia	Phedra		2003	F		28.5	26.5	G	8	SK-543		USM2002-R2	Use extensions 220000RL	USM2002-R2	Use extensions 220000RL
Lancia					R	12.3	10.5	G	3			USM2002-R2		USM2002-R2	
Land Rover	Type	Model	Year	Front	Rear	Max	Min	Drawing	Shim (mm)	QMP	Remarks	USM	Remarks	USM	Remarks
Land Rover															
Land Rover	Freelander	1997..2002		F		14.0	11.0	F	None	SK-515		USM2002-R2		USM2002-R2	
Land Rover				F		20.7		G	5			USM2002-R2		USM2002-R2	
Land Rover	Freelander 2	2007..		F		28.0	26.0	G	15	SK-515		USM2002-R2		USM2002-R2	
Land Rover					R	12.0	10.0	-	-		Use USM ->	USM2002-R2		USM2002-R2	
Land Rover	Evoque	2011..		F		28.0	26.0	G	15	SK-515		USM2002-R2		USM2002-R2	
Land Rover					R	12.0	10.0	-	-		Use USM ->	USM2002-R2		USM2002-R2	
Land Rover	Defender	1999		F		13.0		B	10			USM2002-B3		USM2002-B3	
Land Rover					R	11.0		B	8			USM2002-B3		USM2002-B3	
Land Rover	Discovery	1999		F		25.0	22.0	G	10	SK-517B		USM2002-R2		USM2002-R2	
Land Rover					R	12.7	11.7	G	7			USM2002-R2		USM2002-R2	
Land Rover	Discovery 3	2005..2009		F		30.0	27.0	G	16			USM2002-R2	Use extensions 220000RL	USM2002-R2	
Land Rover					R	20.0	17.0	M	23			USM2002-R2		USM2002-R2	
Land Rover	Discovery 4, Ø 360	2009..		F		30.0	27.0	G	16		Use UP-RL or USM	USM2002-R2	Use extensions 220000RL	USM2002-R2	Use extension 220000RL on the bottom mounting
Land Rover	Ø 350				R	20.0	17.0	G	10			USM2002-R2		USM2002-R2	
Land Rover	Range Rover	1998..2002		F		25.0	22.0	G	10	SK-517B		USM2002-R2		USM2002-R2	
Land Rover					R	12.7	11.7	G	7			USM2002-R2		USM2002-R2	
Land Rover	Range Rover	2002..2009		F		29.0		G	23			USM2002-R2		USM2002-R2	
Land Rover					R	11.5		G	3			USM2002-R2		USM2002-R2	

Land Rover	Range Rover, Ø 360	2009..	F		30.0	27.0	G	16		Use UP-RL or USM		USM2002-R2	Use extensions 220000RL		USM2002-R2	Use extension 220000RL on the bottom mounting
Land Rover	Ø 350			R	20.0	17.0	G	10				USM2002-R2			USM2002-R2	
Land Rover	Range Rover Sport, Ø 360	2009..	F		30.0	27.0	G	16		Use UP-RL or USM		USM2002-R2	Use extensions 220000RL		USM2002-R2	Use extension 220000RL on the bottom mounting
Land Rover	Ø 350			R	20.0	17.0	G	10				USM2002-R2			USM2002-R2	
Land Rover	Ø 380		F		34.0	31.0						-			USM2002-R2	Use extension 220000RL
LDV	Type	Model	Year	Front	Rear	Max	Min	Drawing	Shim (mm)	QMP	Remarks	USM	Remarks		USM	Remarks
LDV	Maxus	2.8 / 120	2005..	F		24		G	18	SK-521B		USM2002-R2			USM2002-R2	
Lexus	Type	Model	Year	Front	Rear	Max	Min	Drawing	Shim (mm)	QMP	Remarks	USM	Remarks		USM	Remarks
Lexus	RX300	MCU15		F		28	26	M	10	SK-524		USM2002-R2			USM2002-R2	
Lexus					R	10	8.5	G	3	SK-523		USM2002-R2			USM2002-R2	
Lexus	RX300	MCU35		F								USM2002-R2	Use extensions 220000RL		USM2002-R2	
Lexus					R							USM2002-R2			USM2002-R2	
Lexus	LX450	JT		F		32	30	M	5	SK-533	Use 4WD drive adapter SK-509C	USM2002-B3	Use 4WD drive adapter SK-509C		USM2002-B3	Use 4WD drive adapter SK-509C
Lexus					R	18	16	G	5	SK-523	Use 4WD drive adapter SK-509C	USM2002-R2	Use 4WD drive adapter SK-509C		USM2002-R2	Use 4WD drive adapter SK-509C
Lexus	LX470	UZJ100		F		32	30	M	5	SK-533	Use 4WD drive adapter SK-509C	USM2002-B3	Use 4WD drive adapter SK-509C		USM2002-B3	Use 4WD drive adapter SK-509C
Lexus					R	17	16					USM2002-R2			USM2002-R2	
Lexus	LS400	UCF10		F		28	26	G	20	SK-520		USM2002-R2			USM2002-R2	
Lexus				F		32	30	G	20	SK-520		USM2002-R2			USM2002-R2	
Lexus					R	15		G	3			USM2002-R2			USM2002-R2	
Lexus		UCF20		F		28	26	Q	13			USM2002-R2	Use extensions 220000RL		USM2002-R2	
Lexus					R	16	15					USM2002-R2			USM2002-R2	
Lexus	LS430	UCF30		F		30	28	-	-	SK-587B	Use SK-417A	Use SK-587B and SK-417A. Drawing AC Use SK-587B and SK-417A. Drawing AD Use SK-587B and SK-417A. Drawing AC Use SK-587B and SK-417A. Drawing AD		Use SK-587B and SK-418A. Drawing AM		
Lexus					R	16	14.5	-	-	SK-587B	Use SK-417A			Use SK-587B and SK-418A. Drawing AN		
Lexus	SC430	UZZ40		F		30	28	-	-	SK-587B	Use SK-417A			Use SK-587B and SK-418A. Drawing AM		
Lexus					R	16	14.5	-	-	SK-587B	Use SK-417A			Use SK-587B and SK-418A. Drawing AN		
Lexus	SC400	UZZ30		F		32	30	G	20	SK-520		USM2002-R2			USM2002-R2	
Lexus	SC300	JZZ31		F		28	26	G	20	SK-520		USM2002-R2			USM2002-R2	
Lexus	GS300	JZS147		F		32	30	G	20	SK-520		USM2002-R2			USM2002-R2	
Lexus					R	12	10.5					USM2002-R2			USM2002-R2	
Lexus	ES300	VCV, MCV		F		28	26	M	8	SK-524		USM2002-R2			USM2002-R2	
Lexus	ES250	VZV2		F		25	24	G	7	SK-522A		USM2002-R2			USM2002-R2	
Lexus	IS200			F		32	30	M	17			USM2002-R2			USM2002-R2	

Lexus				R	12	10.5		G	7		Use short uni.plates SK-532A	G	No space	USM2002-R2	
Lexus	IS300			F		32	30	-	-	SK-555		USM2002-R2		USM2002-R2	
Lexus				R	12	10.5		G	7		Use short uni.plates SK-532A	G	No space	USM2002-R2	
Lexus	LX570			F		32	29					USM2002-R2	Use extensions 220000RL and 4WD drive adapter SK-509C	USM2002-R2	Use extension 220000RL on the bottom mounting, and 4WD drive adapter SK-509C
Lexus				R	18	16		G	7	SK-523	Use 4WD drive adapter SK-509C	USM2002-R2	Use extension 220000RL on the bottom mounting, and 4WD drive adapter SK-509C	USM2002-R2	Use extension 220000RL on the bottom mounting, and 4WD drive adapter SK-509C
L <i>T</i> i	Type	Model	Year	Front	Rear	Max	Min	Drawing	Shim (mm)	QMP	Remarks	USM	Remarks	USM	Remarks
L <i>T</i> i															
L <i>T</i> i	TX1		2002	F		24		G	25	SK-512B	Use SK-570 drive adapter	USM2002-R2	Use SK-570	USM2002-R2	Use SK-570
Maybach	Type	Model	Year	Front	Rear	Max	Min	Drawing	Shim (mm)	QMP	Remarks	USM	Remarks	USM	Remarks
Maybach		57 / 62		F		34.2	31.4			Ask	Use 14 conical rings TM64001				
Maybach				R		32	29.4			Ask	Use 14 conical rings TM64001				
Maserati	Type	Model	Year	Front	Rear	Max	Min	Drawing	Shim (mm)	QMP	Remarks	USM	Remarks	USM	Remarks
Maserati		Biturbo		F		22	20.4					USM2002-R2	Use extensions 220000RL	USM2002-R2	
Maserati				R	10	9						USM2002-R2		USM2002-R2	
Mazda	Type	Model	Year	Front	Rear	Max	Min	Drawing	Shim (mm)	QMP	Remarks	USM	Remarks	USM	Remarks
Mazda															
Mazda	2		2003..	F		22	20	G	7	SK-512B		USM2002-R2		USM2002-R2	
Mazda	3			F		25	23	G				USM2002-R2		USM2002-R2	
Mazda					R	11	9	G				USM2002-R2		USM2002-R2	
Mazda	Carol			F		17	15	F	None	SK-521B		USM2002-R2		USM2002-R2	
Mazda	Demio	DW		F		22	20	B	12	SK-536		USM2002-B3		USM2002-B3	
Mazda	121 1.3	DB		F		12	10	B	15	SK-536		USM2002-B3		USM2002-B3	
Mazda	121 1.25, 1.3	ZQ		F		12	10	G	3	SK-512B		USM2002-R2		USM2002-R2	
Mazda	121 1.8D	ZQ		F		20	18	G	7	SK-512B		USM2002-R2		USM2002-R2	
Mazda	323 1.3, 1.5, 1.6	BG		F		18	16	B	13	SK-536		USM2002-B3		USM2002-B3	
Mazda	323 / Protegé1.5, 1.6	BG		F		22	20	B	13	SK-536		USM2002-B3		USM2002-B3	
Mazda				R	9	7		G	17		Use short uni.plates SK-532A	USM2002-R2		USM2002-R2	

Mazda	323 1.3	BA	F	18	16	B	13	SK-536	USM2002-B3	USM2002-B3
Mazda	323 1.5	BA	F	22	20	B	13	SK-536	USM2002-B3	USM2002-B3
Mazda	323 2.0	BA	F	22	20	G	7	SK-537B	USM2002-R2	USM2002-R2
Mazda			R	9	8	G	10	Use short uni.plates SK-532A	USM2002-R2	USM2002-R2
Mazda	323	BJ	F	22	20	G	7		USM2002-R2	USM2002-R2
Mazda	MX3 1.6, 1.8	EC	F	22	20	B	13	SK-536	USM2002-B3	USM2002-B3
Mazda			R	9	8	G	17	Use short uni.plates SK-532A	G	USM2002-R2
Mazda	5	2005	F	25	23	G	7		USM2002-R2	USM2002-R2
Mazda			R	11	9	G	15		USM2002-R2	USM2002-R2
Mazda	626 1.8, diesel	GD	F	20	18	G	5	SK-537B	USM2002-R2	USM2002-R2
Mazda	626 2.0 automatic	GD	F	24	22	G	3	SK-537B	USM2002-R2	USM2002-R2
Mazda	626 1.8, 2.0	GV	F	22	20	G	5	SK-537B	USM2002-R2	USM2002-R2
Mazda	626 1.8, 2.0, 2.5, 2.0D	GE	F	24	22	G	5	SK-537B	USM2002-R2	USM2002-R2
Mazda			R	10	8	G	18		USM2002-R2	USM2002-R2
Mazda	626	GW,GF	F	24	22	G	5	SK-537B	USM2002-R2	USM2002-R2
Mazda			R	10	8	G	18		USM2002-R2	USM2002-R2
Mazda	626	GF	F	24	22	G			USM2002-R2	Use extensions 220000RL
Mazda			R	10	8	G			USM2002-R2	USM2002-R2
Mazda	6	GG	..2008	F	25	23	G	5	SK-537B	USM2002-R2
Mazda			R	10	8	G	17	SK-519C	USM2002-R2	Turn bow
Mazda	6	GH	2008..2012	F	25	23	G	5	SK-537B	USM2002-R2
Mazda			R	10	8	G	17		USM2002-R2	USM2002-R2
Mazda	6	GJ	2013..	F	28	26	G	12		USM2002-R2
Mazda			R	10	8	G	13		USM2002-R2	USM2002-R2
Mazda	CX-5	2012..	F	28	26	G	12		USM2002-R2	Use extensions 220000RL
Mazda			R	10	8	G	13		USM2002-R2	USM2002-R2
Mazda	929 3.0	HD	F	24	22	G	10	SK-537B	USM2002-R2	USM2002-R2
Mazda			R	18	16	G	5		USM2002-R2	USM2002-R2
Mazda	MX5 1.6	NA	F	20	18	G	12	SK-537B	USM2002-R2	USM2002-R2
Mazda			R	9	8	G	7		USM2002-R2	USM2002-R2
Mazda	Miata 1.8	NA	F	22	20	G	12	SK-537B	USM2002-R2	USM2002-R2
Mazda			R	9	8	G	7		USM2002-R2	USM2002-R2
Mazda	MX6 2.0, 2.5	GE	F	24	22	G	5	SK-537B	USM2002-R2	USM2002-R2
Mazda			R	10	8	G	18		USM2002-R2	USM2002-R2
Mazda	Millenia	NA	F	28	26	G	10	SK-537B	USM2002-R2	USM2002-R2
Mazda			R	9.0	7.5	F	None	Use short uni.plates SK-532A	USM2002-R2	USM2002-R2

Mazda	AZ Wagon - Spiano			F		17	15	F	None		Use small silencer SK-402		USM2002-R2		USM2002-R2
Mazda	Premacy	CP		F		24	22	G	5	SK-537B			USM2002-R2		USM2002-R2
Mazda	MPV			F		28	26	G	10	SK-537B			USM2002-R2		USM2002-R2
Mazda					R	18	16	G	7				USM2002-R2		USM2002-R2
Mazda	Xedos 6 1.6, 2.0	CA		F		24	22	G	5	SK-537B			USM2002-R2		USM2002-R2
Mazda					R	10	8	G	18				USM2002-R2		USM2002-R2
Mazda	Xedos 9 2.0, 2.5	TA		F		28	26	G	10	SK-537B			USM2002-R2		USM2002-R2
Mazda					R	9.0	7.5	F	None		Use short uni.plates SK-532A		USM2002-R2		USM2002-R2
Mazda	RX7			F		28	26	B	7				USM2002-B3		USM2002-B3
Mazda					R	20	18	G	3				USM2002-R2		USM2002-R2
Mazda	RX8			F				G	18		use UP-RL		USM2002-R2	Use extensions 220000RL	USM2002-R2      Use extensions 220000RL
Mazda					R			G	8				USM2002-R2		USM2002-R2
Mazda	Tribute			F		26	24	G	18	SK-517B	Use 4WD drive adapter SK-509C		USM2002-R2	Use SK-509C	USM2002-R2      Use SK-509C
Mazda	E2000			F		20	18	G	7		Use slide SK-511-1		USM2002-R2		USM2002-R2
Mazda	E2200			F		20	18	G	7		Use slide SK-511-1		USM2002-R2	Use extensions 220000RL	USM2002-R2      Use extensions 220000RL
Mazda	Navajo			F		22	20	-	-	SK-505					
Mazda	B2300 / B3000 / B4000			F		22	20	-	-	SK-505					
Mazda	B-trucks 2x4			F		20	18	-	-	SK-505					
Mazda	B-trucks 4x4			F		22	20	-	-	SK-505					
Mazda				F		29	27						USM2002-R2		USM2002-R2
Mercedes Mercedes	Type	Model	Year	Front	Rear	Max	Min	Drawing	Shim (mm)	QMP	Remarks		USM	Remarks	USM      Remarks
Mercedes	A170 CDI	168		F		22	19.4	G	5	SK-538			USM2002-R2		USM2002-R2
Mercedes	Vaneo			F		22	19.4	G	5	SK-538			USM2002-R2		USM2002-R2
Mercedes	190	W201		F		11.0	9.0	G	17	SK-538			USM2002-R2	Turn bow	USM2002-R2      Turn bow
Mercedes					R	9.0	7.3	B	15				USM2002-B3	Remove cap, use shim 5mm	USM2002-B3      Remove cap
Mercedes	300	W124		F		12.0	10.0	G	17	SK-538			USM2002-R2	Turn bow	USM2002-R2      Turn bow
Mercedes				F		22	19.4	G					USM2002-R2	Turn bow	USM2002-R2      Turn bow
Mercedes					R	9.0	7.3	B	15				USM2002-B3		USM2002-B3
Mercedes	B-serie	W246		F		25	23						USM2002-R2		USM2002-R2
Mercedes					R	9	7.3						USM2002-R2		USM2002-R2
Mercedes	C-serie	W202		F		12	10.8	G	17	SK-538			USM2002-R2		USM2002-R2
Mercedes				F		22	19.4	G	17	SK-538			USM2002-R2		USM2002-R2
Mercedes					R	9.0	7.3	B	15				USM2002-B3		USM2002-B3
Mercedes	C-serie	W203		F		25	23	G	17	SK-538			USM2002-R2		USM2002-R2



Mercedes					R	9	7.3	B	13		Use spacer SK-401	USM2002-B3	Use spacer SK-401	USM2002-B3	Use spacer SK-401
Mercedes	E-serie	W210		F		25	23	G	15	SK-538		USM2002-R2		USM2002-R2	
Mercedes	S-serie	W140		F		30	27.4	A	None	SK-539		USM2002-B3	Use extensions 220000BL	USM2002-B3	Use extensions 220000BL
Mercedes					R	12	9.8	B	7			USM2002-B3		USM2002-B3	
Mercedes	S-serie	W220		F		32	30	L	None			USM2002-R2	Use extensions 220000RL	USM2002-R2	
Mercedes					R	22	20	B	None			USM2002-B3		USM2002-B3	
Mercedes	SL	R129	89-93	F		28	25.4	G	22		Use 16 conical rings TM64001	USM2002-R2	Use 16 conical rings TM64001	USM2002-R2	Use 16 conical rings TM64001
Mercedes					R	9	7.3	B	13		Use 16 conical rings TM64001	USM2002-B3	Use 16 conical rings TM64001	USM2002-B3	Use 16 conical rings TM64001
Mercedes	Citan	108 CDI	2012..	F		24	22	A	None			USM2002-B3		USM2002-B3	
Mercedes					R	11	9	F	None			USM2002-R2		USM2002-R2	
Mercedes	Vito	108D		F		22	19	G	18			USM2002-R2		USM2002-R2	
Mercedes					R	10	8	B	12			USM2002-B3	Top bolt M8x25, bottom bolt M10x25	USM2002-B3	Top bolt M8x25, bottom bolt M10x25
Mercedes	Vito	109CDI	2004..	F		28	25	G	20	SK-521B		USM2002-R2		USM2002-R2	
Mercedes					R	10.5	8	G	7	SK-517B		USM2002-R2		USM2002-R2	
Mercedes	MB100			F		16	14	-	-	SK-531		USM2002-B3		USM2002-B3	
Mercedes	Sprinter			F		22	19	G	17			USM2002-R2		USM2002-R2	
Mercedes					R	16	14	G	5			USM2002-R2		USM2002-R2	
Mercedes					F	2006..	28	25	G	18		USM2002-R2		USM2002-R2	
Mercedes					R	16	14	G	17			USM2002-R2		USM2002-R2	
Mercedes	Gelande			F		16	14	N	3		Drill one shim to 16.5	USM2002-B3	Use extensions 220000BL. Drill to 16.5 and turn bow	USM2002-B3	Drill to 16.5 and turn bow
Mercedes	ML	270 CDI	..2001	F		26	23	E	10			x	Use Universal Blue Plates: UP-B1 and 10 mm shim	USM2002-B3	
Mercedes					R	15	13	B	12						
Mercedes	Vario	512 (667)		F		22	19	G	18		Use SK-570 drive adapter	USM2002-R2	Use extensions 220000RL	USM2002-R2	Use extensions 220000RL
Mercedes					R	22	19	G	20		Use SK-570 drive adapter	USM2002-R2	Use extensions 220000RL	USM2002-R2	Use extensions 220000RL
Mercedes		612/712/812 (668/669/670)		F		30	27	R	7	SK-924	Use SK-570 drive adapter	USM2002-R2	Use extensions 220000RL	USM2002-R2	Use extensions 220000RL
Mercedes					R	30	27	-	-	SK-924	Use SK-924 and SK-570 drive adapter	Use SK-924 and SK-570 drive adapter		Use SK-924 and SK-570 drive adapter	
Mercedes					F	815 4x4 (670)	30	27	R	7	Use SK-570 drive adapter	USM2002-R2	Use extensions 220000RL	USM2002-R2	Use extensions 220000RL
Mercedes					R	30	27	-	-	SK-924	Use SK-924 and SK-570 drive adapter	Use SK-924 and SK-570 drive adapter		Use SK-924 and SK-570 drive adapter	
Mercury	Type	Model	Year	Front	Rear	Max	Min	Drawing	Shim (mm)	QMP	Remarks	USM	Remarks	USM	Remarks
Mercury															
Mercury												USM2002-B3			

Mini Mini	Type	Model	Year	Front	Rear	Max	Min	Drawing	Shim (mm)	QMP	Remarks	USM	Remarks	USM	Remarks
Mini	One	Ø280x22	2002..	F		22.0	20.4	G	13	SK-541		USM2002-R2		USM2002-R2	
Mini		Ø259x10			R	10.0	8.4	G	3			USM2002-R2	Use extension 220000RL	USM2002-R2	Use extension 220000RL
Mitsubishi Mitsubishi	Type	Model	Year	Front	Rear	Max	Min	Drawing	Shim (mm)	QMP	Remarks	USM	Remarks	USM	Remarks
Mitsubishi	Colt / Lancer	C50..C70	89..92	F		13.0	11.4	G	7	SK-518A		USM2002-R2		USM2002-R2	
Mitsubishi				F		18.0	16.4	G	7	SK-518A		USM2002-R2		USM2002-R2	
Mitsubishi				F		24.0	22.4	G	7	SK-518A		USM2002-R2		USM2002-R2	
Mitsubishi					R	10.0	8.4	F	None			USM2002-R2		USM2002-R2	
Mitsubishi		CA0..CD0	92..	F		13.0	11.4	G	7	SK-518A		USM2002-R2		USM2002-R2	
Mitsubishi				F		18.0	16.4	G	7	SK-518A		USM2002-R2		USM2002-R2	
Mitsubishi				F		24.0	22.4	G	7	SK-518A		USM2002-R2		USM2002-R2	
Mitsubishi					R	10.0	8.4	F	None			USM2002-R2		USM2002-R2	
Mitsubishi		CJ1, CJ4, CK1, CK4	96..	F		18.0	16.4	G	7	SK-518A		USM2002-R2		USM2002-R2	
Mitsubishi		Z30	04...	F		24	22	G	8	SK-518A		USM2002-R2		USM2002-R2	
Mitsubishi					R	10	8	F	None		Turn lower uni.plate Use short uni.plates SK- 532A				
Mitsubishi	Lancer Evo V			F		32.0	30.4	R	3			USM2002-R2	Use extensions 220000RL	USM2002-R2	Use extensions 220000RL
Mitsubishi					R	22.0	20.4	G	7			USM2002-R2		USM2002-R2	
Mitsubishi	Lancer Evo VI / VII / VIII / VIII			F		32.0	30.4	R	3		Use short uni.plates SK- 532A	USM2002-R2	Use extensions 220000RL	USM2002-R2	Use extensions 220000RL
Mitsubishi					R	22.0	20.4	G	7			USM2002-R2		USM2002-R2	
Mitsubishi	Lancer Evo X			F		32.0	30.4	R	3		Use SK-589	Use SK-589		USM2002-R2	Use extensions 220000RL
Mitsubishi					R	22.0	20.4	G	7			USM2002-R2		USM2002-R2	
Mitsubishi	Lancer Wagon	C10, C30	84..92	F		13.0	11.4	G	7	SK-518A		USM2002-R2		USM2002-R2	
Mitsubishi				F		18.0	16.4	G	7	SK-518A		USM2002-R2		USM2002-R2	
Mitsubishi		CB0..CD0	92..	F		18.0	16.4	G	7	SK-518A		USM2002-R2		USM2002-R2	
Mitsubishi				F		24.0	22.4	G	7	SK-518A		USM2002-R2		USM2002-R2	
Mitsubishi					R	10.0	8.4	F	None			USM2002-R2		USM2002-R2	
Mitsubishi	Lancer	CS3	04..	F		26	24	G	8	SK-518A		USM2002-R2		USM2002-R2	
Mitsubishi					R	10.0	8.4	F	None			USM2002-R2		USM2002-R2	
Mitsubishi	Carisma	DA2A	95..	F		24.0	22.4	G	8	SK-518A		USM2002-R2		USM2002-R2	
Mitsubishi					R	10.0	8.4	-	-	SK-563		SK-563		Use SK-532 and SK-422	
Mitsubishi	Galant	E30	88..92	F		18.0	16.4	G	7	SK-518A		USM2002-R2		USM2002-R2	
Mitsubishi				F		24.0	22.4	G	7	SK-518A		USM2002-R2		USM2002-R2	
Mitsubishi					R	10.0	8.4	F	None			USM2002-R2		USM2002-R2	
Mitsubishi		E50, E80	93..	F		24.0	22.4	G	7	SK-518A		USM2002-R2		USM2002-R2	
Mitsubishi					R	20.0	18.4	F	None			USM2002-R2		USM2002-R2	
Mitsubishi					R	10.0	8.4	F	None			USM2002-R2		USM2002-R2	

Mitsubishi	EA2A	97..	F		24.0	22.4	G	7	SK-518A		USM2002-R2		USM2002-R2
Mitsubishi				R	10.0	8.4	F	None			USM2002-R2		USM2002-R2
Mitsubishi	Galant Wagon	EA2W	97..	F		24.0	22.4	G	7	SK-518A		USM2002-R2	USM2002-R2
Mitsubishi					R	10.0	8.4	F	None		USM2002-R2		USM2002-R2
Mitsubishi	Space Wagon	D00W	..91	F		18.0	16.4	G	7	SK-518A		USM2002-R2	USM2002-R2
Mitsubishi				F		24.0	22.4	G	7	SK-518A		USM2002-R2	USM2002-R2
Mitsubishi		N30, N40	92..99	F		24.0	22.4	G	7	SK-518A		USM2002-R2	USM2002-R2
Mitsubishi					R	10.0	8.4	F	None	SK-518A		USM2002-R2	USM2002-R2
Mitsubishi		N80	99..	F		24.0	22.4	G	10	SK-537B		USM2002-R2	USM2002-R2
Mitsubishi					R	20.0	18.4	G	5			USM2002-R2	USM2002-R2 Use extensions 220000RL
Mitsubishi	Space Runner	N10, N20	92..99	F		24.0	22.4	G	7	SK-518A		USM2002-R2	USM2002-R2
Mitsubishi					R	10.0	8.4	F	None	SK-518A	F		F Use SK-422
Mitsubishi		N63	99.	F		24	22.4	G	10	SK-537B	USM2002-R2		USM2002-R2
Mitsubishi					R	10	8.4	F		SK-518A	F		F Use SK-422
Mitsubishi	Space Star	DG1	98..	F		24.0	21.5	G	8	SK-518A	USM2002-R2		USM2002-R2
Mitsubishi					R	10	8.4	M	5	SK-562	M Use SK-562 and SK-422	Use SK-562 and SK-421	
Mitsubishi	Space Gear	PA4W	95..	F		24.0	22.4	G	10		USM2002-R2		USM2002-R2
Mitsubishi	Grandis		04..	F		26	24.2	G	10	use UP RL	USM2002-R2	Use extensions 220000RL	USM2002-R2
Mitsubishi					R	10	8.4	F	None		USM2002-R2		USM2002-R2
Mitsubishi	Sigma	F10, F20	91..	F		24.0	22.4	G	7	SK-518A	USM2002-R2		USM2002-R2
Mitsubishi					R	18.0	16.4	G	3	SK-518A	USM2002-R2		USM2002-R2
Mitsubishi	Sigma Wagon	FO7W	91..	F		24.0	22.4	G	7	SK-518A	USM2002-R2		USM2002-R2
Mitsubishi					R	20.0	18.4	G	3	SK-518A	USM2002-R2		USM2002-R2
Mitsubishi	Outlander		2003...2006	F		25	22.4	G	8		USM2002-R2	Use extensions 220000RL	USM2002-R2
Mitsubishi					R			F	None		USM2002-R2		USM2002-R2
Mitsubishi			2007...2012	F		24	22.4				USM2002-R2		USM2002-R2
Mitsubishi					R	10	8				USM2002-R2		USM2002-R2
Mitsubishi			2013...	F		24	22.4	G	8		USM2002-R2	Use extensions 220000RL	USM2002-R2
Mitsubishi					R	10	8	G	13		USM2002-R2		USM2002-R2
Mitsubishi	Pajero	L040,L140	89..90	F		22.0	20.4	G	10	SK-518A	USM2002-R2	Use 4WD drive adapter SK-509C	USM2002-R2 Use 4WD drive adapter SK-509C
Mitsubishi		V20, V40	91..	F		24.0	22.4	G	12	SK-518A	USM2002-R2	Use 4WD drive adapter SK-509C	USM2002-R2 Use 4WD drive adapter SK-509C
Mitsubishi				F		27.0	25.4	G	12	SK-518A	USM2002-R2	Use 4WD drive adapter SK-509C	USM2002-R2 Use 4WD drive adapter SK-509C
Mitsubishi					R	18.0	16.4	G	3	SK-518A	USM2002-R2	Use 4WD drive adapter SK-509C	USM2002-R2 Use 4WD drive adapter SK-509C
Mitsubishi	Pajero Pinin		99..	F		22	20.4	G	7		USM2002-R2	Use extensions 220000RL	USM2002-R2
Mitsubishi					R	9.2	8.4	F	None	SK-518A	USM2002-R2		USM2002-R2

Mitsubishi	Pajero V6 3000 SWB	V23W	99..	F		24	22.4					USM2002-R2		USM2002-R2
Mitsubishi	Pajero V6 3500 LWB	V45W	99..	F		27	25.4					USM2002-R2	Use extensions 220000RL	USM2002-R2
Mitsubishi	Pajero	V46W	99..	F		22.4	22.4					USM2002-R2		USM2002-R2
Mitsubishi	Pajero 2000 / Montero	CK	2000..	F		26	24	G	10			USM2002-R2		USM2002-R2
Mitsubishi	Pajero 2000 / Montero	CK	2000..		R	22	20.4	G	5			USM2002-R2		USM2002-R2
Mitsubishi	Pajero Sport / Nativa / Chalanger / Montero sport		99..	F		24	22.4	G	10		Use UP-RL1	USM2002-R2	Use extensions 220000RL	USM2002-R2 Use extensions 220000RL
Mitsubishi	L200	K00T	90..	F		22.0	20.4	G	10	SK-518A		USM2002-R2		USM2002-R2
Mitsubishi				F		24.0	22.4	G	10	SK-518A		USM2002-R2		USM2002-R2
Mitsubishi	L200		2006..	F		28.0	26					USM2002-R2	Use extensions 220000RL	USM2002-R2 Use extensions 220000RL
Mitsubishi	L300	P00	87..	F		22.0	20.4	G	10	SK-518A		USM2002-R2		USM2002-R2
Mitsubishi	L400	PA, PB, PD	95..	F		24.0	22.4	G	10	SK-518A		USM2002-R2		USM2002-R2
Mitsubishi	Eclipse	D10	92..	F		24.0	22.4	G	7	SK-518A		USM2002-R2		USM2002-R2
Mitsubishi					R	10.0	8.4	F	None			USM2002-R2		USM2002-R2
Mitsubishi	3000GT	Z10	92..	F		30.0	28.4	G	17			USM2002-R2		USM2002-R2
Mitsubishi					R	20.0	18.4	G	7	SK-518A		USM2002-R2		USM2002-R2
Mitsubishi	Canter			F		40.0	38.0					USM2002-R2	Use DL8702 and SK-570	USM2002-R2 Use SK-570
Nissan	Type	Model	Year	Front	Rear	Max	Min	Drawing	Shim (mm)	QMP	Remarks	USM	Remarks	USM Remarks
Nissan	Micra	K10		F		13	11	D	3			USM2002-B3		USM2002-B3
Nissan				F		15	13	D	3			USM2002-B3		USM2002-B3
Nissan		K11		F		12	10	F	None	SK-517B		USM2002-R2		USM2002-R2
Nissan		K12		F		22	19.8	G	13	SK-517B		USM2002-R2		USM2002-R2
Nissan	Note	E11		F		22	20	G	13	SK-517B		USM2002-R2		USM2002-R2
Nissan		E12		F		22	20					USM2002-R2		USM2002-R2
Nissan	Yuke	F15		F		24	22					USM2002-R2		USM2002-R2
Nissan					R	9	7					USM2002-R2		USM2002-R2
Nissan	Sunny	N13, B12		F		12	10	G	3	SK-517B		USM2002-R2		USM2002-R2
Nissan				F		18	16	F	None	SK-517B		USM2002-R2		USM2002-R2
Nissan				F		20	18	F	None	SK-517B		USM2002-R2		USM2002-R2
Nissan					R	10	8	G	3			USM2002-R2		USM2002-R2
Nissan		N14		F		18	16	F	None	SK-517B		USM2002-R2		USM2002-R2
Nissan				F		26	24	F	None	SK-517B		USM2002-R2		USM2002-R2
Nissan					R	10	8	G	3			USM2002-R2		USM2002-R2
Nissan		Y10		F		18	16	F	None	SK-517B		USM2002-R2		USM2002-R2
Nissan	Almera	N15		F		18	16	F	None	SK-517B		USM2002-R2		USM2002-R2
Nissan					R	7	6	G	10		Use short uni.plates SK-532A	G	Use short uni.plates SK-532	USM2002-R2

Nissan	Almera	N16	F	18	16	F	None	SK-517B		USM2002-R2		USM2002-R2
Nissan			R	7	6	G	10		Use short uni.plates SK-532A	G	Use short uni.plates SK-532	USM2002-R2
Nissan	Almera Tino	V10	F	28	26	G	18	SK-517B		USM2002-R2		USM2002-R2
Nissan			R	10	9	F	None			USM2002-R2		USM2002-R2
Nissan	Bluebird	T12, U11, T72	F	22	20	G	18			USM2002-R2		USM2002-R2
Nissan	Primera	P10	F	20	18	H	10	SK-517B		USM2002-R2		USM2002-R2
Nissan			F	22	20	H	10	SK-517B		USM2002-R2		USM2002-R2
Nissan			R	11	9	G	10			G		USM2002-R2
Nissan	Primera	W10	F	22	20	G	13	SK-517B		USM2002-R2		USM2002-R2
Nissan			R	10	8	G	10			G		USM2002-R2
Nissan		P11	F	22	20	G	18	SK-517B		USM2002-R2		USM2002-R2
Nissan			R	10	9	F	None		Use short uni.plates SK-532A	F	Use short uni.plates SK-532	USM2002-R2
Nissan		P12	F	28	26	G	18	SK-519C		USM2002-R2		USM2002-R2
Nissan			R	10	9	G	5			USM2002-R2		USM2002-R2
Nissan	Qashqai		F	26	24	G	17	SK-537B		USM2002-R2		USM2002-R2
Nissan			R	9	8	G	5	SK-532	Use short uni.plates SK-532A	USM2002-R2		USM2002-R2
Nissan	Maxima	J30	F	22	20	G	20	SK-519C		USM2002-R2		USM2002-R2
Nissan			R	11	9	G	7			USM2002-R2		USM2002-R2
Nissan			F	26	24	F	None	SK-517B		USM2002-R2		USM2002-R2
Nissan			R	10	8	G	3			USM2002-R2		USM2002-R2
Nissan		A32	F	22	20	G	18	SK-517B		USM2002-R2		USM2002-R2
Nissan			R	9	8	G	8			USM2002-R2		USM2002-R2
Nissan		A33	F	28	26	G	18	SK-517B		USM2002-R2		USM2002-R2
Nissan			R	9	8	G	5			USM2002-R2		USM2002-R2
Nissan	100NX	B13	F	18	16	F	None	SK-517B		USM2002-R2		USM2002-R2
Nissan			F	26	24	F	None	SK-517B		USM2002-R2		USM2002-R2
Nissan			R	10	8	G	3			USM2002-R2		USM2002-R2
Nissan	200SX	S13	F	22	20	G	17	SK-517B		USM2002-R2		USM2002-R2
Nissan			R	10	8	G	3			USM2002-R2		USM2002-R2
Nissan		S14	F	30	28	L	3	SK-519C		USM2002-R2		USM2002-R2
Nissan			R	10	8	G	17		Use short uni.plates SK-532A	G	Use short uni.plates SK-532	USM2002-R2
Nissan	300ZX	Z32	F	30	28	L	3	SK-519C		USM2002-R2		USM2002-R2
Nissan			R	18	16	G	7		Use short uni.plates SK-532A	USM2002-R2		USM2002-R2
Nissan	Prairie	M11	F	22	20	H	10	SK-517B		USM2002-R2		USM2002-R2
Nissan			F	26	24	G	20	SK-517B		USM2002-R2		USM2002-R2
Nissan	Serena	C23	F	26	24	G	17	SK-517B		USM2002-R2		USM2002-R2
Nissan	X-Trail	T30	F	28	26	G	18	SK-517B		USM2002-R2		USM2002-R2

Nissan				R	16	14	G	10			USM2002-R2		USM2002-R2			
Nissan	X-Trail	T31		F	26	24	G	18			USM2002-R2		USM2002-R2			
Nissan				R	16	14	G	10	Use short uni.plates SK-532A		G	Use short uni.plates SK-532	USM2002-R2			
Nissan	X-Trail	T32		F	28	26					USM2002-R2		USM2002-R2			
Nissan				R	16	14	G	10	Use short uni.plates SK-532A		G	Use short uni.plates SK-532	USM2002-R2			
Nissan	Patrol	260		F	20	18	G	10	SK-517B	Use 4WD drive adapter SK-509C	USM2002-R2	Use 4WD drive adapter SK-509C	USM2002-R2	Use 4WD drive adapter SK-509C		
Nissan				Y60	F	20	18	G	17	SK-517B	Use 4WD drive adapter SK-509C	USM2002-R2	Use 4WD drive adapter SK-509C	USM2002-R2	Use 4WD drive adapter SK-509C	
Nissan				R	18	16	G	20	SK-517B	Use 4WD drive adapter SK-509C	USM2002-R2	Use 4WD drive adapter SK-509C	USM2002-R2	Use 4WD drive adapter SK-509C		
Nissan				F	26	24	F	None	Use 4WD drive adapter SK-509C		USM2002-R2	Use 4WD drive adapter SK-509C	USM2002-R2	Use 4WD drive adapter SK-509C		
Nissan				R	18	16	G	20	SK-517B	Use 4WD drive adapter SK-509C	USM2002-R2	Use 4WD drive adapter SK-509C	USM2002-R2	Use 4WD drive adapter SK-509C		
Nissan				Y61	F	32	30	R	3	Use 4WD drive adapter SK-509C	USM2002-R2	Use extensions 220000RL and 4WD drive adapter SK-509C	USM2002-R2	Use extensions 220000RL and 4WD drive adapter SK-509C		
Nissan				R	18	16	G	18	SK-517B	Use 4WD drive adapter SK-509C	USM2002-R2	Use 4WD drive adapter SK-509C	USM2002-R2	Use 4WD drive adapter SK-509C		
Nissan	Quest										USM2002-B3		USM2002-B3			
Nissan	Kingcab 2WD	D21		F	22	20	G	20	SK-517B	Use 4WD drive adapter SK-509C	USM2002-R2	Use 4WD drive adapter SK-509C	USM2002-R2	Use 4WD drive adapter SK-509C		
Nissan			Kingcab 4WD	D21	F	26	24	G	20	SK-517B	Use 4WD drive adapter SK-509C	USM2002-R2	Use 4WD drive adapter SK-509C	USM2002-R2	Use 4WD drive adapter SK-509C	
Nissan	Pickup 2WD	D22		F	26	24	G	18	SK-517B			USM2002-R2	USM2002-R2			
Nissan	Pickup 4WD	D22		F	26	24	G	18	SK-517B			USM2002-R2	USM2002-R2			
Nissan	Navara	D40		F	28	26	G	18			USM2002-R2	USM2002-R2				
Nissan				Terrano	WD21	F	26	24	L	5	SK-519C	Use 4WD drive adapter SK-509C	USM2002-R2	Use 4WD drive adapter SK-509C	USM2002-R2	Use 4WD drive adapter SK-509C
Nissan				R	18	16	G	7	SK-517B	Use 4WD drive adapter SK-509C	USM2002-R2	Use 4WD drive adapter SK-509C	USM2002-R2	Use 4WD drive adapter SK-509C		
Nissan			Terrano II	R20	F	26	24	G	20	SK-517B	Use 4WD drive adapter SK-509C	USM2002-R2	Use 4WD drive adapter SK-509C	USM2002-R2	Use 4WD drive adapter SK-509C	
Nissan	Pathfinder			F	28	26	G	18			USM2002-R2	USM2002-R2				
Nissan	Urvan	E24		F	26	24	L	5	SK-519C			USM2002-R2	USM2002-R2			
Nissan	Vanette	C22		F	20	18	G	17	SK-517B			USM2002-R2	USM2002-R2			
Nissan			van	C22	F	22	20	G	17	SK-517B			USM2002-R2	USM2002-R2		
Nissan	coach	C22		F	26	24	G	17	SK-519C			USM2002-R2	USM2002-R2			

Nissan	cargo	C23		F		26	24	G	15	SK-519C		USM2002-R2		USM2002-R2	
Nissan	Trade	312		F		24	22	-	-	SK-531		USM2002-B3		USM2002-B3	
Nissan	Trade 100	KE30		F		24	22	-	-	SK-531		USM2002-B3		USM2002-B3	
Nissan	Kubistar			F		20.1	17.7	B	5	SK-550A		USM2002-B3		USM2002-B3	
Nissan	Primastar		2002	F		28	24	A	None	SK-550A		USM2002-B3	Use extensions 220000BL	USM2002-B3	
Nissan					R	12	10	G	10	SK-537B		USM2002-R2	In case of metal dustcover, use: SK-537B, shim 5 (2x) , M10x60 (2x)	USM2002-R2	In case of metal dustcover, use: SK-537B, shim 5 (2x) , M10x60 (2x). SK-422
Nissan	Interstar			F		28		A	None			USM2002-B3	Use extensions 220000BL	USM2002-B3	Use extensions 220000BL
Nissan					R	12	10.5	G	10			USM2002-R2		USM2002-R2	
Nissan	Cabstar	F22	..2007	F		20	18	L	5	SK-519C		USM2002-R2		USM2002-R2	
Nissan		F23	..2007	F		26	24	L	5	SK-519C		USM2002-R2		USM2002-R2	
Nissan	Cabstar E75	TL0	..2007	F		24	22	-	-	x		x		x	
Oldsmobile	Type	Model	Year	Front	Rear	Max	Min	Drawing	Shim (mm)	QMP	Remarks	USM	Remarks	USM	Remarks
Oldsmobile	Bravada		98..	F		29.2		K	None		Use SK-407 bolts	USM2002-R2		USM2002-R2	
Oldsmobile	Silhouette		2000	F		32		M	25			USM2002-R2		USM2002-R2	
Oldsmobile					R	11		G	7	SK-527A		USM2002-R2		USM2002-R2	
Opel	Type	Model	Year	Front	Rear	Max	Min	Drawing	Shim (mm)	QMP	Remarks	USM	Remarks	USM	Remarks
Opel	Agila			F		12	10	G	3	SK-521B		USM2002-R2		USM2002-R2	
Opel	Corsa	B	1993..2000	F		12.7	9.7	B	13	SK-535		USM2002-B3		USM2002-B3	
Opel				F		20	17	D	8			USM2002-B3		USM2002-B3	
Opel	Corsa	D	2006..2014	F		22	20	G	12			USM2002-R2		USM2002-R2	
Opel		E	2014..	F								USM2002-R2		USM2002-R2	
Opel					R							USM2002-R2		USM2002-R2	
Opel	Kadett			F		12.5	9.7					USM2002-B3		USM2002-B3	
Opel	Astra	F, CC		F		20	17	C	5			USM2002-B3		USM2002-B3	
Opel		G		F		20	17	B	10	SK-535		USM2002-B3		USM2002-B3	
Opel				F		24	21	C	8		Use M9 bolts SK-411 on caliper	C	Use M9 bolts SK-411 on caliper	USM2002-B3	Use M9 bolts SK-411 on caliper
Opel				F		25	22	B	7			USM2002-B3		USM2002-B3	
Opel					R	10	8	G	17			USM2002-R2		USM2002-R2	
Opel		H	2004..2010	F		25	22	B	7			USM2002-R2		USM2002-B3	
Opel					R	10	8	G	17			USM2002-R2		USM2002-R2	
Opel		J	2010..	F		26	24	G	13			USM2002-R2		USM2002-R2	
Opel					R	12	10	G	13		Use short uni.plates SK-532A	USM2002-R2		USM2002-R2	
Opel	Zafira			F		25	22	D	7			USM2002-B3		USM2002-B3	
Opel	Vectra	A		F		12.7	10.7	B	13	SK-535		USM2002-B3		USM2002-B3	
Opel				F		20	17	B	10	SK-535		USM2002-B3		USM2002-B3	

Opel	B			F		24	21	B	7	SK-535		USM2002-B3		USM2002-B3		
Opel				R		10	8	B	12			USM2002-B3		USM2002-B3		
Opel	C			F		25	23					USM2002-R2		USM2002-R2		
Opel				R		10	8					USM2002-R2		USM2002-R2		
Opel	Insignia			F		30	28					USM2002-R2		Use extensions 220000RL	USM2002-R2	
Opel				R		22	20					USM2002-R2		USM2002-R2		
Opel	Omega	B	F		24	21	B	10			USM2002-B3		USM2002-B3			
Opel				R		12	10	B	12			USM2002-B3		USM2002-B3		
Opel	Senator	B	F		28	25	B	5			USM2002-B3		USM2002-B3			
Opel				R		10	8	B	13			USM2002-B3		USM2002-B3		
Opel	Campo			F		22	20.6	G	10	SK-542	Use slide SK-511-1	USM2002-R2		Use DL8702 or SK-511-1	USM2002-R2	
Opel	Antara	2006..	F		29	27	G	8				USM2002-R2		Use extensions 220000RL	USM2002-R2	
Opel				R		20	18.4					USM2002-R2		USM2002-R2		
Opel	Frontera			F		22	20.6	G	10	SK-542	Use slide SK-511-1	USM2002-R2		Use DL8702 or SK-511-1	USM2002-R2	
Opel				F		26	24.6	G	10	SK-542		USM2002-R2		USM2002-R2		
Opel				R		18	16.6	G	7			USM2002-R2		USM2002-R2		
Opel	Monterey			F		26	24.6	G	10	SK-542	USM2002-R2		USM2002-R2			
Opel				R		18	16.6	G	7			USM2002-R2		USM2002-R2		
Opel	Combo	2001..	F		24	21	G	7	SK-517B			USM2002-R2		USM2002-R2		
Opel	Vivaro	2002..	F		28	24	A	None	SK-550A			USM2002-B3		Use extensions 220000BL	USM2002-B3	
Opel				R		12	10	G	10	SK-537B			USM2002-R2		In case of metal dustcover, use: SK-537B, shim 5 (2x) , M10x60 (2x) , SK-422	In case of metal dustcover, use: SK-537B, shim 5 (2x) , M10x60 (2x), SK-422
Opel	Movano	3500	F		28			A	None			USM2002-B3		Use extensions 220000BL	USM2002-B3	
Opel				R		12	10.5	G	10			USM2002-R2		USM2002-R2		
Opel	Zafira Tourer	2012..	F		26	24	G	13			USM2002-R2		Use extensions 220000RL	USM2002-R2		
Peugeot Peugeot	Type	Model	Year	Front	Rear	Max	Min	Drawing	Shim (mm)	QMP	Remarks	USM		Remarks	USM	Remarks
Peugeot	106		1991..2004	F		8	6	B	13		Use SK-401	USM2002-B3		Use SK-401 on top mounting	USM2002-B3	Use SK-401 on top mounting
Peugeot				F		10	8	D	10	SK-554	USM2002-B3		USM2002-B3			
Peugeot				F		20.4	18.5	B	5	SK-554	USM2002-B3		USM2002-B3			
Peugeot	107		2006..2014	F		20	18	G	7	SK-522A	USM2002-R2		USM2002-R2			
Peugeot	1007	Ø266	2005..2009	F		22	20					USM2002-B3		USM2002-B3		
Peugeot	Ø247			F		9	7					USM2002-R2		USM2002-R2		
Peugeot	205		1983..1999	F		10	8	D	8	SK-554	USM2002-B3		USM2002-B3			
Peugeot	206		1998..2012	F		10	8	B	10	SK-554	USM2002-B3		USM2002-B3			
Peugeot	207, 207 SW		2006..2014	F		26	24	A	None			USM2002-B3		USM2002-B3		
Peugeot				R		9	7	G	18	SK-512B	USM2002-R2		USM2002-R2			
Peugeot	306		1993..2003	F		10	8	B	10	SK-554	USM2002-B3		USM2002-B3			



Peugeot			F		20.4	18.4	B	5	SK-554		USM2002-B3		USM2002-B3	
Peugeot			F		22	20	C	3	SK-554		USM2002-B3		USM2002-B3	
Peugeot				R	8	6	B	8			USM2002-B3		USM2002-B3	
Peugeot	307, 307 SW	2001..	F		26	24	A	None			USM2002-B3		USM2002-B3	
Peugeot				R	9	7	G	18			USM2002-B3	Use M10 bolts and nuts	USM2002-B3	Use M10 bolts and nuts
Peugeot	308	2008..	F		26	24	A	None			USM2002-B3		USM2002-B3	
Peugeot				R	12	10	G	17			USM2002-R2	Use extensions 220000RL	USM2002-R2	Use extensions 220000RL
Peugeot	309	1985..1993	F		10	8	D	8	SK-554		USM2002-B3		USM2002-B3	
Peugeot	405	1987..1996	F		10	8	B	8	SK-554		USM2002-B3		USM2002-B3	
Peugeot	406	1995..2005	F		24	22	B	3	SK-554		USM2002-B3		USM2002-B3	
Peugeot			F		26	24	B	3	SK-554		USM2002-B3		USM2002-B3	
Peugeot			F		28	26	A	None			USM2002-B3		USM2002-B3	
Peugeot				R	10	8	B	12			USM2002-B3	Use 3 mm shim (8740112) on top mounting	USM2002-B3	Use 3 mm shim (8740112) on top mounting
Peugeot	407, 407 SW	2004..	F		28	26	G	10			USM2002-R2		USM2002-R2	
Peugeot				R	12	10	G	None			USM2002-R2		USM2002-R2	
Peugeot	508	2011..	F		28	26	G	10			USM2002-R2		USM2002-R2	
Peugeot				R	12	10					USM2002-R2		USM2002-R2	
Peugeot	605	1989..2000	F		26	24	G	8	SK-554		USM2002-R2		USM2002-R2	
Peugeot				R	10	8	B	12			USM2002-B3		USM2002-B3	
Peugeot	607	1999..2011	F		32	30	M	17			USM2002-R2		USM2002-R2	
Peugeot				R	10	8	B	12			USM2002-B3	Use insert 8,5 and 10,5	USM2002-B3	Use insert 8,5 and 10,5
Peugeot	806	1994..2003	F		26.0	24.2	G	8	SK-543		USM2002-R2	Silencer does not fit	USM2002-R2	
Peugeot				R	10	8	G	3			USM2002-R2	Better: Universal red	USM2002-R2	
Peugeot	807	2003..2014	F		28.5	26.5	G	8	SK-543		USM2002-R2	Use extensions 220000RL	USM2002-R2	Use extensions 220000RL
Peugeot				R	12.3	10.5	G	3			USM2002-R2		USM2002-R2	
Peugeot	4007	2007..2012	F		24	22.4					USM2002-R2		USM2002-R2	
Peugeot				R	10	8					USM2002-R2		USM2002-R2	
Peugeot	5008	2009..	F		26	24	A	None			USM2002-B3		USM2002-B3	
Peugeot				R	12	10	G	20			USM2002-R2		USM2002-R2	
Peugeot	Bipper	2008..	F		22	20	G	10			USM2002-R2		USM2002-R2	
Peugeot	Partner	1996..2008	F		13	11	A	None	SK-554		USM2002-B3		USM2002-B3	
Peugeot			F		20.4	18.4	C	3	SK-554		USM2002-B3		USM2002-B3	
Peugeot		2008..	F		26	24	A	None			USM2002-B3		USM2002-B3	
Peugeot				R	12	10	G	17			USM2002-R2	Use extensions 220000RL	USM2002-R2	Use extensions 220000RL
Peugeot	Partner Tepee	2008..	F		26	24	A	None			USM2002-B3		USM2002-B3	
Peugeot				R	12	10	G	17			USM2002-R2	Use extensions 220000RL	USM2002-R2	Use extensions 220000RL
Peugeot	Expert	1996..2007	F		20.4	18.2	G	10	SK-543		USM2002-R2		USM2002-R2	
Peugeot		2007..	F		28	26					USM2002-R2		USM2002-R2	

Peugeot					R	14	12					USM2002-R2		USM2002-R2	
Peugeot	Boxer 270 , 310 , 320		1994..2006	F		18	15.9	G	15			USM2002-R2		USM2002-R2	
Peugeot	310/320 ABS, 350		1994..2006	F		24	21.9	G	17			USM2002-R2		USM2002-R2	
Peugeot	Boxer 330		1994..2006	F		24	22	G	18	SK-537B		USM2002-R2		USM2002-R2	
Peugeot					R	16.2	14.2	G	10			USM2002-R2		USM2002-R2	
Peugeot	Boxer 330		2006..	F		24	22	G	25			USM2002-R2		USM2002-R2	
Peugeot					R	16	14	G	15			USM2002-R2		USM2002-R2	
Peugeot	Boxer		2006..	F		24	22.4	G	25			USM2002-R2		USM2002-R2	
Peugeot					R	16	14	G	12			USM2002-R2		USM2002-R2	
Piaggio	Type	Model	Year	Front	Rear	Max	Min	Drawing	Shim (mm)	QMP	Remarks	USM	Remarks	USM	Remarks
Piaggio	Porter	Maxxi	2010	F		16	14					USM2002-B3		USM2002-B3	
Plymouth	Type	Model	Year	Front	Rear	Max	Min	Drawing	Shim (mm)	QMP	Remarks	USM	Remarks	USM	Remarks
Plymouth	Neon	PL		F		20.0	18.4	E	13	SK-545		USM2002-B3		USM2002-B3	
Plymouth					R	9.0	7.25	E	3			USM2002-B3		USM2002-B3	
Pontiac	Type	Model	Year	Front	Rear	Max	Min	Drawing	Shim (mm)	QMP	Remarks	USM	Remarks	USM	Remarks
Pontiac	Montana		2000	F		32		M	25			USM2002-R2		USM2002-R2	
Pontiac					R	11		G	7	SK-527A		USM2002-R2		USM2002-R2	
Pontiac	Trans Sport		2000	F		32		M	25			USM2002-R2		USM2002-R2	
Pontiac					R	11		G	7	SK-527A		USM2002-R2		USM2002-R2	
Porsche	Type	Model	Year	Front	Rear	Max	Min	Drawing	Shim (mm)	QMP	Remarks	USM	Remarks	USM	Remarks
Porsche	911 SC	911	..89	F		20.0	18.0	A	None			USM2002-B3		USM2002-B3	
				R				B	10		Use SK-421	Use SK-421		Use SK-421	
Porsche	911	964	89..93	F		28.0	26.6	-	-	SK-587B	Use SK-587B and SK-431	Use SK-587B and SK-431. Drawing AE		Use SK-587B and SK-432. Drawing AG	
Porsche					R	24.0	22.6	B	5			USM2002-B3		USM2002-B3	
Porsche	911	993	94..97	F		32.0	30.6	-	-	SK-587B	Use SK-587B and SK-431	Use SK-587B and SK-431. Drawing AF		Use SK-587B and SK-432. Drawing AE	
Porsche					R	24.0	22.6	B	5			USM2002-B3	Turn bow, remove plastic mudguard	USM2002-B3	Turn bow
Porsche	911	996	97..	F		28.0	26.6	-	-	SK-587B	Use SK-587B and SK-431	Use SK-587B and SK-431. Drawing AE		Use SK-587B and SK-432. Drawing AG	
Porsche					R	24.0	22.6	-	-	SK-587B	Use SK-587B and SK-431	Use SK-587B and SK-431. Drawing AG		Use SK-587B and SK-432. Drawing AP	
Porsche	911 Turbo	996	2003	F		34.0		-	-	SK-587B	Use SK-587B and SK-431	Use SK-587B and SK-431. Drawing AH		Use SK-587B and SK-432. Drawing AQ	
Porsche					R	28.0		-	-			Use DA2002, SK-587B and SK-432. Drawing AS		Use SK-587B and SK-432. Drawing AS	
Porsche	928			F		28	26.6			SK-587B	Use SK-587B and SK-431	Use SK-587B and SK-431. Drawing AE		Use SK-587B and SK-432. Drawing AG	
Porsche	944			F		28	26.6			SK-587B	Use SK-587B and SK-431	Use SK-587B and SK-431		Use SK-587B and SK-432	

Porsche	968			F		28	26.6			SK-587B	Use SK-587B and SK-431	Use SK-587B and SK-431	Use SK-587B and SK-432		
Porsche	Boxster	986	97..	F		28.0	26.6	-	-	SK-587B	Use SK-587B and SK-431	Use SK-587B and SK-431. Drawing AE	Use SK-587B and SK-432. Drawing AG		
Porsche					R	24.0	22.6	-	-	SK-587B	Use SK-587B and SK-431	Use SK-587B and SK-431. Drawing AG	Use SK-587B and SK-432. Drawing AP		
Porsche	Cayenne S		2003	F		34.0		E	13		Use UP-BL1 and shim 13	USM2002-B3	Use extensions 220000BL, drill hole to 16 mm	USM2002-B3	Use extensions 220000BL, drill hole to 16 mm
Porsche					R	28		P	3		Mount uni Yellow with original calliper bolts.	USM2002-B3	Use extensions 220000BL	USM2002-B3	Use extensions 220000BL
Porsche	Panamera		2011..	F		34.0		-	-	SK-587B	Use SK-587B and SK-444	Use SK-587B and SK-444. Drawing AT	Use SK-587B and SK-445. Drawing AV		
Proton	Type	Model	Year	Front	Rear	Max	Min	Drawing	Shim (mm)	QMP	Remarks	USM	Remarks	USM	Remarks
Proton	Putra			F		24	22.4	G	7			USM2002-R2		USM2002-R2	
Renault	Type	Model	Year	Front	Rear	Max	Min	Drawing	Shim (mm)	QMP	Remarks	USM	Remarks	USM	Remarks
Renault	Twingo	C063		F		8	7	B	10	SK-550A		USM2002-B3		USM2002-B3	
Renault	5	B40, C40		F		12	10.5	B	8	SK-550A		USM2002-B3		USM2002-B3	
Renault	Clio	C57		F		12	10.5	B	8	SK-550A		USM2002-B3		USM2002-B3	
Renault				F		20	18	B	5	SK-550A		USM2002-B3		USM2002-B3	
Renault	Clio, Clio Estate		2006..2012	F		22	20	G	13	SK-517B		USM2002-R2		USM2002-R2	
Renault					R	8	7	F	None		Use short uni.plates SK-532A	USM2002-R2		USM2002-R2	
Renault	Clio		2012..	F		22	20	G	12			USM2002-R2		USM2002-R2	
Renault					R										
Renault	Modus			F		22	20					USM2002-R2		USM2002-R2	
Renault				R		8	7					USM2002-R2		USM2002-R2	
Renault	Captur		2013..	F		24	22					USM2002-R2		USM2002-R2	
Renault	9	L42		F		12	10.5					USM2002-B3		USM2002-B3	
Renault	19	B53		F		12	10.5	B	8	SK-550A		USM2002-B3		USM2002-B3	
Renault		L53		F		20	18.3	B	5	SK-550A		USM2002-B3		USM2002-B3	
Renault	Mégane	BA0F,LA0F		F		20	18.3	B	5	SK-550A		USM2002-B3		USM2002-B3	
Renault		KAOW		F		21	19	B	5	SK-550A		USM2002-B3		USM2002-B3	
Renault	Mégane	JA0F		F		22	19.8	B	3	SK-550A		USM2002-B3		USM2002-B3	
Renault	Mégane II	BMO, CMO	2003	F		22	19.8	A	None	SK-550A		USM2002-B3		USM2002-B3	
Renault					R	8	7	F	None			USM2002-R2		USM2002-R2	
Renault	21	L48		F		20	18	B	5	SK-550A		USM2002-B3		USM2002-B3	
Renault		B48		F		20.5	17.7	G	10	SK-551		USM2002-R2		USM2002-R2	
Renault	Laguna	B56,K56		F		22	19.8	B	3	SK-550A		USM2002-B3		USM2002-B3	
Renault				F		24	21.8	B	3	SK-550A		USM2002-B3		USM2002-B3	
Renault					R	10.5	9.5	B	13	SK-550A		B		USM2002-B3	
Renault		BGOG		F		26	24	A	None	SK-550A		USM2002-B3		USM2002-B3	

Renault			2008	F		26	24	G	20			USM2002-R2		USM2002-R2	
Renault					R	11	9	G	3			USM2002-R2		USM2002-R2	
Renault	25	B29		F		20.2	17.7	B	3	SK-551		USM2002-B3		USM2002-B3	
Renault				F		22	20	B	3	SK-551		USM2002-B3		USM2002-B3	
Renault					R	12	10.5	G	3			USM2002-R2		USM2002-R2	
Renault	Safrane	B54		F		22	19.8	B	3	SK-550A		USM2002-B3		USM2002-B3	
Renault				F		24	21.8	B	3	SK-550A		USM2002-B3		USM2002-B3	
Renault	Vel Satis	BJO	2002	F		28	25.4	N	None			USM2002-B3	Use extensions 220000BL	USM2002-B3	Use extensions 220000BL
Renault					R	10.5	9.5	F	None			USM2002-R2		USM2002-R2	
Renault	Espace	J63		F		20	18	B	5	SK-551		USM2002-B3		USM2002-B3	
Renault		JEO	1999	F		24	21.8	A	None			USM2002-B3		USM2002-B3	
Renault					R	10.5	9.5	B	8 / 6	Use shim Ø22xØ12,5x8		USM2002-B3		USM2002-B3	
Renault		JEO	2001	F		24	21.8	A	None			USM2002-B3		USM2002-B3	
Renault					R	10.5	9.5	F	None			USM2002-R2		USM2002-R2	
Renault		JKO	2003..2014	F		28	25.4	N	None			USM2002-B3	Use extensions 220000BL	USM2002-B3	Use extensions 220000BL
Renault					R	10.5	9.5	F	None			USM2002-R2		USM2002-R2	
Renault		RFC	2015..	F		28	26					USM2002-R2	Use extensions 220000RL	USM2002-R3	Use extensions 220000RL
Renault					R	11	9					USM2002-R2		USM2002-R2	
Renault	Express	F40U		F		12	10	D	8	SK-550A		USM2002-B3		USM2002-B3	
Renault	Kangoo	FC, KC	..2008	F		20.1	17.7	B	5	SK-550A		USM2002-B3		USM2002-B3	
Renault	Kangoo		2008..	F		24	22	A	None			USM2002-B3		USM2002-B3	
Renault					R	11	9	F	None			USM2002-R2		USM2002-R2	
Renault	Trafic	T42F		F		24	22	G	5	Use slide SK-511-1		USM2002-R2	Use extensions 220000RL	USM2002-R2	Use extensions 220000RL
Renault		Ø305x28	2003..2014	F		28	24	A	None	SK-550A		USM2002-B3	Use extensions 220000BL	USM2002-B3	
Renault		Ø280x12			R	12	10	G	10	SK-537B		USM2002-R2	In case of metal dustcover, use: SK-537B, shim 5 (2x) , M10x60 (2x)	USM2002-R2	In case of metal dustcover, use: SK-537B, shim 5 (2x) , M10x60 (2x). SK-422
Renault		Ø295x28	2014..	F		28	24	G	10			USM2002-R2		USM2002-R2	
Renault		Ø280x12			R	12	10					USM2002-R2	Use extensions 220000RL and sim 5	USM2002-R2	Use extensions 220000RL and shim 5
Renault	Master T28	XDOX		F		24	21	G	15	SK-542	Use 4WD drive adapter SK-509C	USM2002-R2	Use 4WD drive adapter SK-509C	USM2002-R2	Use 4WD drive adapter SK-509C
Rolls Royce	Type	Model	Year	Front	Rear	Max	Min	Drawing	Shim (mm)	QMP	Remarks	USM	Remarks	USM	Remarks
Rolls Royce															
Rolls Royce	Silver Spirit / Silver Spur		80..89	F								USM2002-B3		USM2002-B3	
Rolls Royce					R							USM2002-B3		USM2002-B3	
Rover	Type	Model	Year	Front	Rear	Max	Min	Drawing	Shim (mm)	QMP	Remarks	USM	Remarks	USM	Remarks
Rover															
Rover	200			F		12.8	10.7	G	3	SK-515		USM2002-R2		USM2002-R2	

Rover	400			F		12.8	10.7	G	3	SK-515		USM2002-R2		USM2002-R2	
Rover	416			F		21	19	G	6			USM2002-R2		USM2002-R2	
Rover	600			F		23	21	B	7	SK-515		USM2002-B3		USM2002-B3	
Rover					R	10	8	B	3			USM2002-B3		USM2002-B3	
Rover	800			F		21	19	B	5	SK-515		USM2002-B3		USM2002-B3	
Rover					R	10	8	A	3			USM2002-B3		USM2002-B3	
Saab	Type	Model	Year	Front	Rear	Max	Min	Drawing	Shim (mm)	QMP	Remarks	USM	Remarks	USM	Remarks
Saab	99 / 90		1984	F		12.7	11.7	N	10			USM2002-B3		USM2002-B3	
Saab					R	10.5	9.5		None		Use Yellow Short Plates SK-531 and Universal Red Plates UP-R1	Use Yellow Short Plates SK-531 and Universal Red Plates UP-R0		Use Yellow Short Plates SK-531, Universal Red Plates UP-R1 and special bolts SK-421	
Saab	900 S		1995	F		24	21	B	7			USM2002-B3		USM2002-B3	
Saab					R	10	8	B	15			USM2002-B3		USM2002-B3	
Saab	9000		1985..1998	F		23.5	21.5					USM2002-B3		USM2002-B3	
Saab	9-2X		2004	F		24	22	G	8	SK-525		USM2002-R2		USM2002-R2	
Saab					R	10	8					USM2002-R2		USM2002-R2	
Saab	9-3		2002	F		25	22	D	7			USM2002-B3	Use extensions 220000BL	USM2002-B3	
Saab					R	10	8	B	12	SK-535		USM2002-B3		USM2002-B3	
Saab	9-3	Viggen	2002	F		25	22	D	7		Use UP-BL1	USM2002-B3	Use extensions 220000BL	USM2002-B3	Use extensions 220000BL
Saab					R	10	8	B	12	SK-535		USM2002-B3		USM2002-B3	
Saab	9-5		1999	F		25	22	B	7			USM2002-B3		USM2002-B3	
Saab					R	10	8	A	None			USM2002-B3		USM2002-B3	
Saab	9-5		2002	F		25	22	G	10			USM2002-R2		USM2002-R2	
Saab					R	10	8	A	None	SK-535		USM2002-B3		USM2002-B3	
Saab	9-5	Aero / TiD	2002	F		28	22	G	10			USM2002-R2		USM2002-R2	
Saab					R	10	8	A	None	SK-535		USM2002-B3		USM2002-B3	
Saipa	Type	Model	Year	Front	Rear	Max	Min	Drawing	Shim (mm)	QMP	Remarks	USM	Remarks	USM	Remarks
Saipa	Parand			F		13	11	B	15		Use small silencer SK-402	USM2002-B3		USM2002-B3	
Saipa	Nasim			F		13	11	B	15		Use small silencer SK-402	USM2002-B3		USM2002-B3	
Saipa	Saba			F		13	11	B	15		Use small silencer SK-402	USM2002-B3		USM2002-B3	
Saipa	Safari			F		13	11	B	15		Use small silencer SK-402	USM2002-B3		USM2002-B3	
Saipa	Carvan			F		13	11	B	15		Use small silencer SK-402	USM2002-B3		USM2002-B3	
Scion	Type	Model	Year	Front	Rear	Max	Min	Drawing	Shim	QMP	Remarks	USM	Remarks	USM	Remarks

(mm)															
Scion	FR-S	2012..		F		24	22	G	7			USM2002-R2	Use extensions 220000RL	USM2002-R2	
				R		18	16	G	12		Use short uni.plates SK-532A	G	Use short uni.plates SK-532A	USM2002-R2	
Seat	Type	Model	Year	Front	Rear	Max	Min	Drawing	Shim (mm)	QMP	Remarks	USM	Remarks	USM	Remarks
Seat	Mii	2012..		F		22	20	B	5			USM2002-B3		USM2002-B3	
Seat	Arosa			F		18	16	C	7			USM2002-B3	Use universal plates	USM2002-B3	
Seat				F		20	18	D	8			USM2002-B3		USM2002-B3	
					R	9	7	G	15			G		USM2002-B3	
Seat	Ibiza			F		12	10	C	7			USM2002-B3		USM2002-B3	
Seat	Cordoba			F		12	10	C	7			USM2002-B3		USM2002-B3	
Seat				F		20	18	C	7			C		USM2002-B3	
				F		22	19	C	13		Use M9 bolts SK-411 on caliper	USM2002-B3	Use SK-411	USM2002-B3	Use M9 bolts SK-411 on caliper
Seat					R	9	7	G	18			USM2002-R2		USM2002-R2	
Seat	Leon			F		22	19	C	12		Use SK-420 and SK-411	Use SK-411, SK-420 and universal plates		USM2002-B3	Use SK-411
Seat					R	9	7	G	17	SK-590		Use SK-590		Use SK-590	
Seat	Altea	2004		F		22	19	C	12		Use M9 bolts SK-411 on caliper	Use SK-411, SK-420 and universal plates		USM2002-B3	Use SK-411
Seat					R	9	7	G	17	SK-590		Use SK-590		Use SK-590	
Seat	Toledo	IV		F		12	10	C	7			USM2002-B3		USM2002-B3	
Seat		1M		F		22	19	C	12		Use M9 bolts SK-411 on caliper	Use SK-411, SK-420 and universal plates		USM2002-B3	Use SK-411, SK-420
					R	9	7	G	15	SK-590		Use SK-590		Use SK-590	
Seat	Exeo	2009..		F		25	23	G	12			USM2002-R2	Use extensions 220000RL	USM2002-R2	Use extensions 220000RL
					R	12	10	F	None			USM2002-R2	Use extensions 220000RL	USM2002-R2	Use extensions 220000RL
Seat	Alhambra			F		25	23	N	5	SK-553		USM2002-B3	Use extensions 220000BL	USM2002-B3	
Seat	Alhambra V6 4x4			F		26	22	R	10			USM2002-R2	Silencer does not fit	USM2002-R2	
Seat					R	10	8	F	None	SK-512B		USM2002-R2		USM2002-R2	
Skoda	Type	Model	Year	Front	Rear	Max	Min	Drawing	Shim (mm)	QMP	Remarks	USM	Remarks	USM	Remarks
Skoda	Citigo	2012..		F		22	20	B	5			USM2002-B3		USM2002-B3	
				F		22.0	19.0	C	12		Use M9 bolts SK-411 on caliper	Use SK-411 and universal plates		USM2002-B3	Use SK-411
					R	9.0	7.0	G	17			USM2002-R2		USM2002-R2	
Skoda	Favorit			F		12.9	11.4	G	13	SK-528		USM2002-R2		USM2002-R2	
Skoda	Felicia			F		12.9	11.4	G	13	SK-528		USM2002-R2		USM2002-R2	

Skoda	Felicia Kombi, Pick-Up			F		12.9	11.4	G	3	SK-528		USM2002-R2		USM2002-R2
Skoda	Roomster			F		22.0	19.0	C	12	A	Use M9 bolts SK-411 on caliper	Use SK-411, SK-425 and universal plates		USM2002-B3      Use SK-411
Skoda					R	9	7	G	17			USM2002-R2	Silencer does not fit	USM2002-R2      Silencer does not fit
Skoda	Octavia			F		22.0	19.0	C	13			C		USM2002-B3
Skoda				F		22.0	19.0	C	12		Use M9 bolts SK-411 on caliper	Use SK-411 and universal plates		Use SK-411,
Skoda					R	9.0	7.0	G	17	SK-590		Use SK-590		Use SK-590
Skoda	Superb		.. 2008	F		25	23	D	7			USM2002-B3		USM2002-B3
Skoda					R	10	8	H	3			USM2002-R2		USM2002-R2
Skoda			2008 ..	F		25	23	G	12			USM2002-R2	Use extensions 220000RL	USM2002-R2
Skoda					R	12	10					x		Use long red universal plates, shim 20, M10x75 and SK-422
Skoda	Rapid		2013..	F		22.0	19.0	C	12	A	Use M9 bolts SK-411 on caliper	Use SK-411, SK-425 and universal plates		USM2002-B3      Use SK-411
Smart	Type	Model	Year	Front	Rear	Max	Min	Drawing	Shim (mm)	QMP	Remarks	USM	Remarks	USM      Remarks
Smart	Smart			F		9	8	F	None			USM2002-R2	Use extensions 220000RL	USM2002-R2      Use extensions 220000RL
Ssang Yong	Type	Model	Year	Front	Rear	Max	Min	Drawing	Shim (mm)	QMP	Remarks	USM	Remarks	USM      Remarks
Ssang Yong	Musso			F		24	22	G	6			USM2002-R2		USM2002-R2
Ssang Yong					R	10.5	8.5	B	12			USM2002-B3		USM2002-B3
Ssang Yong	Korando			F		24	22	G	8			USM2002-R2		USM2002-R2
Ssang Yong					R	10.5	8.5	B	12			USM2002-B3		USM2002-B3
Ssang Yong	Actyon		2005..	F		28	26	G	7			USM2002-R2	Use extensions 220000RL	USM2002-R2      Use extensions 220000RL
Ssang Yong					R	10.5	8.5	B	12			USM2002-B3		USM2002-B3
Ssang Yong	Kyron		2005..	F		28	26	M	10			USM2002-R2	Use extensions 220000RL	USM2002-R2      Use extensions 220000RL
Ssang Yong					R	10.5	8.5	B	10			USM2002-B3		USM2002-B3
Ssang Yong	Rexton 270			F		26	23.4	G	7			USM2002-R2		USM2002-R2
Ssang Yong					R	10.5	8.5	B	12			USM2002-B3		USM2002-B3
Ssang Yong	Rexton 290		..2004	F		24	22	G	7			USM2002-R2		USM2002-R2
Ssang Yong					R	10.5	8.5	B	12			USM2002-B3		USM2002-B3
Ssang Yong	Rexton 290		2004..	F		26	23.4	G	7			USM2002-R2		USM2002-R2
Ssang Yong					R	10.5	8.5	B	12			USM2002-B3		USM2002-B3
Subaru	Type	Model	Year	Front	Rear	Max	Min	Drawing	Shim (mm)	QMP	Remarks	USM	Remarks	USM      Remarks
Subaru	Jumbo	M80		F		9	7.5	F	None			USM2002-R2		USM2002-R2
Subaru	Justy			F		18.0	15.5	G	3	SK-525		USM2002-R2		USM2002-R2
Subaru	Impreza			F		24	22	G	8	SK-525		USM2002-R2		USM2002-R2

Subaru	Impreza	WRX		F		24	22	G	7			USM2002-R2	Use extensions 220000RL	USM2002-R2	
Subaru	L-series			F		18	16	G	5	SK-525		USM2002-R2		USM2002-R2	
Subaru	Traviq	2002		F		25	22	D	7			USM2002-B3		USM2002-B3	
Subaru	Forester	2002..2008		F		24	22	G	7	SK-525		USM2002-R2		USM2002-R2	
Subaru					R	10	8					USM2002-R2		USM2002-R2	
Subaru		2008..		F		24	22	G	7	SK-525		USM2002-R2		USM2002-R2	
Subaru					R	10	8	G	8			USM2002-R2		USM2002-R2	
Subaru	Legacy			F		18	16	G	7	SK-525		USM2002-R2		USM2002-R2	
Subaru	Legacy Outback			F		24	22	G	7	SK-525		USM2002-R2		USM2002-R2	
Subaru	Legacy Outback	2005		F								USM2002-R2	Use extensions 220000RL	USM2002-R2	
Subaru	BRZ		2012..	F		24	22	G	7			USM2002-R2	Use extensions 220000RL	USM2002-R2	
Subaru					R	18	16	G	12		Use short uni.plates SK- 532A	G	Use short uni.plates SK-532A	USM2002-R2	
Suzuki	Type	Model	Year	Front	Rear	Max	Min	Drawing	Shim (mm)	QMP	Remarks	USM	Remarks	USM	Remarks
Suzuki	Alto	SH410		F		17	15	F	None	SK-521B		USM2002-R2		USM2002-R2	
Suzuki	Swift	SA413		F		10	8	D	17			USM2002-B3		USM2002-B3	
Suzuki		SF310, SF413		F		17	15	F	None	SK-521B		USM2002-B3		USM2002-B3	
Suzuki		SF413, SF416		F		18.5	16.5	G	5	SK-521B		USM2002-R2		USM2002-R2	
Suzuki		MZC215		F		20	18	G	5	SK-521B		USM2002-R2		USM2002-R2	
Suzuki	Baleno I, II	SY413, SY416		F		20	18	G	3	SK-521B		USM2002-R2		USM2002-R2	
Suzuki	Liana			F		20	18	G	3	SK-521B		USM2002-R2		USM2002-R2	
Suzuki	SY418			F		20	18	G	3	SK-521B		USM2002-R2		USM2002-R2	
Suzuki					R	10	8	G	10			USM2002-R2		USM2002-R2	
Suzuki	Terios		2006..	F		16	14					USM2002-R2		USM2002-R2	
Suzuki	Jimny	SN413		F		10	8	F	None	SK-521B		USM2002-R2	Turn bow	USM2002-R2	Turn bow
Suzuki	Vitara	SV620, SV420D/G SE416	1988..1998	F		22	20	G	13	SK-521B		USM2002-R2		USM2002-R2	
Suzuki				F		10	8	F	None	SK-521B		USM2002-R2		USM2002-R2	
Suzuki	Grand Vitara	SQ625W-3	1988..1998	F		22	20	G	13	SK-521B	Use 4WD drive adapter SK- 509C	USM2002-R2		USM2002-R2	
Suzuki	Grand Vitara XL-7	JA627-W	1998..2006	F		22	20	G	13	SK-521B	Use 4WD drive adapter SK- 509C	USM2002-R2		USM2002-R2	
Suzuki	Grand Vitara		2005..2015	F		25	23					USM2002-R2		USM2002-R2	
Suzuki					R	16	14					USM2002-R2		USM2002-R2	
Suzuki	Vitara 2WD		2015..	F		22	20					USM2002-R2		USM2002-R2	
Suzuki					R	8.8	8					USM2002-R2		USM2002-R2	
Suzuki	SX4		2007..	F		22	20	G	7			USM2002-R2		USM2002-R2	
Suzuki	Wagon R+			F		17	15	F	None		Use small silencer SK- 402	USM2002-R2		USM2002-R2	



Suzuki	Carry			F		17	15	F	None		Use small silencer SK-402	USM2002-R2		USM2002-R2	
Talbot	Type	Model	Year	Front	Rear	Max	Min	Drawing	Shim (mm)	QMP	Remarks	USM	Remarks	USM	Remarks
Talbot															
Talbot	Matra Murena			F		11	9.9	G	20			USM2002-R2		USM2002-R2	
Talbot					R	11	9.9					USM2002-R2		USM2002-R2	
Tata	Type	Model	Year	Front	Rear	Max	Min	Drawing	Shim (mm)	QMP	Remarks	USM	Remarks	USM	Remarks
Tata															
Tata	Telcoline			F		20	18					USM2002-R2		USM2002-R2	
Toyota	Type	Model	Year	Front	Rear	Max	Min	Drawing	Shim (mm)	QMP	Remarks	USM	Remarks	USM	Remarks
Toyota															
Toyota	Aygo		2006..	F		20	18	G	7	SK-522A		USM2002-R2		USM2002-R2	
Toyota	Yaris	SCP10		F		18	16	G	5	SK-522A		USM2002-R2		USM2002-R2	
Toyota	Yaris Verso	NCP2		F		20	18	G	3	SK-522A		USM2002-R2		USM2002-R2	
Toyota	Yaris TS	ZSP90	2007..	F		22	20	G	5	SK-523		USM2002-R2		USM2002-R2	
Toyota				F		9	7.5	G	20		Use short uni.plates SK-532A	USM2002-R2		USM2002-R2	
Toyota	Tercel	EL4, EL5		F		11	10	G	3	SK-522A		USM2002-R2		USM2002-R2	
Toyota				F		18	17	G	7	SK-522A		USM2002-R2		USM2002-R2	
Toyota	Starlet	EP8, NP8		F		11	10	B	12			USM2002-R2		USM2002-R2	
Toyota				F		16	15	B	15						
Toyota				F		18	17	G	3	SK-522A		USM2002-R2		USM2002-R2	
Toyota	Corolla	AE, EE, CE		F		18	17	G	3	SK-522A		USM2002-R2		USM2002-R2	
Toyota				F		22	21	G	5	SK-522A		USM2002-R2		USM2002-R2	
Toyota				F		22	20	G	5	SK-522A		USM2002-R2		USM2002-R2	
Toyota				F		25	23	G	7	SK-522A		USM2002-R2		USM2002-R2	
Toyota					R	9	8	F	None			USM2002-R2		USM2002-R2	
Toyota		AE G6(R)			R	9	7.5	-	-			USM2002-R2	Use extension 220000RL on the bottom mounting	USM2002-R2	Use extension 220000RL on the bottom mounting
Toyota	Corolla 4-door sedan	E150	2007..	F		22	19	G	8			USM2002-R2		USM2002-R2	
Toyota					R	9	7.5	G	20		Use short uni.plates SK-532A	G	Use short uni.plates SK-532A	USM2002-R2	
Toyota	Auris	ZRE151L	2007..2012	F		22	19	G	8			USM2002-R2		USM2002-R2	
Toyota					R	9	7.5	G	17			USM2002-R2		USM2002-R2	
Toyota		ZWE186L	2012..	F		28	26	G	5			USM2002-R2	Use extension 220000RL	USM2002-R2	
Toyota					R	10	8	G	17		Use short uni.plates SK-532A	G	Use short uni.plates SK-532A	USM2002-R2	
Toyota	Corolla Verso		2001..2004	F		25	23	G	7	SK-522A		USM2002-R2		USM2002-R2	

Toyota				R	9	8	D	18		D	Use Universal Blue Plates: UP-B1 and 18 mm shim	D	Use universal blue plates: UP-B1 and 20 mm shim
Toyota	Corolla Verso	2004..	F		26	24	G	5	SK-568	USM2002-R2	Use extensions 220000RL	USM2002-R2	
Toyota				R	10	8.5	H	3	SK-532A	USM2002-R2		USM2002-R2	
Toyota	Prius	NHW11	F		25	23	G	7	SK-522A	USM2002-R2		USM2002-R2	
Toyota				R	9	7.5	D	17		USM2002-B3		USM2002-B3	
Toyota	Corona	AT, ST, CT, YT	F		18	17	G	3	SK-522A	USM2002-R2		USM2002-R2	
Toyota			F		22	21	G	7	SK-522A	USM2002-R2		USM2002-R2	
Toyota			F		22	20	G	7	SK-522A	USM2002-R2		USM2002-R2	
Toyota			F		25	24	G	7	SK-522A	USM2002-R2		USM2002-R2	
Toyota			F		28	26	M	5		USM2002-R2		USM2002-R2	
Toyota	Carina II	AT, ST, CT, YT	F		18	17	G	3	SK-522A	USM2002-R2			
Toyota			F		22	21	G	7	SK-522A	USM2002-R2		USM2002-R2	
Toyota			F		22	20	G	7	SK-522A	USM2002-R2		USM2002-R2	
Toyota			F		25	24	G	7	SK-522A	USM2002-R2		USM2002-R2	
Toyota			F		28	26	M	5					
Toyota	Carina E	AT, ST, CT, YT	F		18	17	G	3	SK-522A	USM2002-R2		USM2002-R2	
Toyota			F		22	21	G	7	SK-522A	USM2002-R2		USM2002-R2	
Toyota			F		22	20	G	7	SK-522A	USM2002-R2		USM2002-R2	
Toyota			F		25	24	G	7	SK-522A	USM2002-R2		USM2002-R2	
Toyota			F		28	26	M	5		USM2002-R2		USM2002-R2	
Toyota		T18, ST18	F		18	16	G	3	SK-522A	USM2002-R2		USM2002-R2	
Toyota			F		22	20	G	7	SK-522A	USM2002-R2		USM2002-R2	
Toyota			F		25	23	G	7	SK-522A	USM2002-R2		USM2002-R2	
Toyota	Avensis	T22	F		25	23	G	7	SK-522A	USM2002-R2		USM2002-R2	
Toyota				R	10	8	G			USM2002-R2		USM2002-R2	
Toyota	Avensis Verso		F		25	23	G	7	SK-522A	USM2002-R2		USM2002-R2	
Toyota				R	12	10.5	F	None	SK-517B	USM2002-R2		USM2002-R2	
Toyota	Avensis	T25	2003	F		26	24	G	7	SK-568	USM2002-R2	Use extensions 220000RL	USM2002-R2
Toyota				R	10	9			SK-532	SK-532		USM2002-R2	
Toyota				R	12	10.5	F	None		USM2002-R2		USM2002-R2	
Toyota	Avensis	T27	2009	F		26	24		Use USM2002-R2, with extensions 220000RL	USM2002-R2	Use extensions 220000RL	USM2002-R2	Use extensions 220000RL
Toyota				R	11	9	G	17		USM2002-R2	Use extension 220000RL on the bottom mounting	USM2002-R2	
Toyota	Avalon	MCX	F		28	26	M	8	SK-524	USM2002-R2		USM2002-R2	
Toyota	Celica	ST20, AT20	F		25	23	G	7	SK-522A	USM2002-R2		USM2002-R2	

Toyota				F		28	26	M	5		USM2002-R2		USM2002-R2	
Toyota				F		32	30	N	3		USM2002-B3		USM2002-B3	
Toyota	Celica TS	ZZT231		F		25	23	G	7	SK-522A	USM2002-R2		USM2002-R2	
Toyota					R	9	7.5	D	17		D		USM2002-B3	
Toyota	MR2	SW2		F		25	23	M	3		USM2002-B3		USM2002-B3	
Toyota				F		30	28	M	5					
Toyota		ZZW30		F		20	19	G	5	SK-522A	USM2002-R2		USM2002-R2	
Toyota					R	16	15	F	None	Use short uni.plates SK-532A, remove plastic mudshield in fender	F	Use short uni.plates SK-532, remove plastic mudshield in fender	USM2002-R2	Remove plastic mudshield in fender
Toyota	GT86	ZN6ALE8	2012..	F		24	22	G	7		USM2002-R2	Use extensions 220000RL	USM2002-R2	
Toyota					R	18	16	G	12	Use short uni.plates SK-532A	G	Use short uni.plates SK-532A	USM2002-R2	
Toyota	Camry	SXV, VCV, MCV		F		28	26	M	8	SK-524	USM2002-R2		USM2002-R2	
Toyota		SV, VZV		F		18	17	G	3	SK-522A	USM2002-R2		USM2002-R2	
Toyota				F		22	21	G	7	SK-522A	USM2002-R2		USM2002-R2	
Toyota				F		25	24	G	7	SK-522A	USM2002-R2		USM2002-R2	
Toyota				F		25	23	G	7	SK-522A	USM2002-R2		USM2002-R2	
Toyota					R	10	9	G	3		USM2002-R2		USM2002-R2	
Toyota		ACV30L, MCV30L		F		28	26	G	7	SK-537B	USM2002-R2	Use extensions 220000RL	USM2002-R2	
Toyota					R	10	8.5	G	7	SK-543	USM2002-R2		USM2002-R2	
Toyota		ACV30R		F		28	26	G	7	SK-537B	USM2002-R2	Use extensions 220000RL	USM2002-R2	
Toyota					R	12	10.5	G	7	SK-543	USM2002-R2		USM2002-R2	
Toyota	Supra	JZA80		F		30	28	G	20	SK-520	USM2002-R2		USM2002-R2	
Toyota				F		32	30	Q	17		USM2002-R2	Use extensions 220000RL	USM2002-R2	
Toyota		MA70		F		22	21	G	13	SK-524	USM2002-R2		USM2002-R2	
Toyota				F		22	20	G	13	SK-524	USM2002-R2		USM2002-R2	
Toyota	Cressida	MX, RX, GX,		F		22	21	G	10	SK-522A	USM2002-R2		USM2002-R2	
Toyota		YX, LX		F		20	19	G	10	SK-522A	USM2002-R2		USM2002-R2	
Toyota				F		22	21	G	10	SK-522A	USM2002-R2		USM2002-R2	
Toyota	Crown	MS, GS, YS,												
Toyota		LS, JZS		F		22	21	G	12	SK-522A	USM2002-R2		USM2002-R2	
Toyota				F		26	25	G	12	SK-522A	USM2002-R2		USM2002-R2	
Toyota	Picnic			F		28	26	G	7	SK-537B	USM2002-R2		USM2002-R2	
Toyota	Previa	TCR1+2		F		22	20	G	3	SK-529	USM2002-R2		USM2002-R2	
Toyota				F		25	23	G	3	SK-529	USM2002-R2		USM2002-R2	
Toyota		ACR30		F		28	26	G	7	SK-524	USM2002-R2		USM2002-R2	
Toyota					R	12	10.5	F	None	SK-522A	USM2002-R2		USM2002-R2	

Toyota	Liteace	KM, YM, CM		F	20	19	F	None		USM2002-R2		USM2002-R2		
Toyota		KR, YR, CR		F	25	23	G	3		USM2002-R2		USM2002-R2		
Toyota	Hiace	RZH		F	22	20	G	10	SK-523	USM2002-R2		USM2002-R2		
Toyota		LH		F	25	23	G	12	SK-522A	USM2002-R2		USM2002-R2		
Toyota		LXH, RZH		F	28	26	G	15	SK-523	USM2002-R2		USM2002-R2		
Toyota	Hilux	YN, RN, LN, VZN		F	20	18	G	10	SK-522A	Use 4WD drive adapter SK-509C	USM2002-B3	Use 4WD drive adapter SK-509C	USM2002-B3	Use 4WD drive adapter SK-509C
Toyota				F	22	20	G	10	SK-522A	Use 4WD drive adapter SK-509C	USM2002-B3	Use 4WD drive adapter SK-509C	USM2002-B3	Use 4WD drive adapter SK-509C
Toyota				F	25	23	G	13	SK-522A	Use 4WD drive adapter SK-509C	USM2002-B3	Use 4WD drive adapter SK-509C	USM2002-B3	Use 4WD drive adapter SK-509C
Toyota				F	30	28	G	13	SK-522A	Use 4WD drive adapter SK-509C	USM2002-B3	Use 4WD drive adapter SK-509C	USM2002-B3	Use 4WD drive adapter SK-509C
Toyota	RAV4	SXA10	1994..2000	F	18	16	G	5	SK-522A		USM2002-R2	USM2002-R2		
Toyota		ACA20, ZCA25R	2000..2006	F	25	23	G	7	SK-537B		USM2002-R2	USM2002-R2		
Toyota				R	9	8	D	18			USM2002-B3	USM2002-B3		
Toyota		ACA30, ALA30	2006..	F	28	26	G	5	SK-523		USM2002-R2	USM2002-R2		
Toyota				R	12	10.5	G	3	SK-532A	Use short uni.plates SK-532A	USM2002-R2	USM2002-R2		
Toyota	4Runner (SW)	YN, RN, VZN, LN		F	20	18	B	5	SK-523	Use 4WD drive adapter SK-509C	USM2002-B3	Use 4WD drive adapter SK-509C	USM2002-B3	Use 4WD drive adapter SK-509C
Toyota				F	25	23	B	5	SK-523	Use 4WD drive adapter SK-509C	USM2002-B3	Use 4WD drive adapter SK-509C	USM2002-B3	Use 4WD drive adapter SK-509C
Toyota	T100 Grandlux	VCK, RCK		F	25	23	B	5	SK-523	Use 4WD drive adapter SK-509C	USM2002-B3	Use 4WD drive adapter SK-509C	USM2002-B3	Use 4WD drive adapter SK-509C
Toyota	Land Cruiser	70		F	12.5	11.0	B	3	SK-523	Use 4WD drive adapter SK-509C	USM2002-B3	Use 4WD drive adapter SK-509C	USM2002-B3	Use 4WD drive adapter SK-509C
Toyota				F	20	18	B	5	SK-523	Use 4WD drive adapter SK-509C	USM2002-B3	Use 4WD drive adapter SK-509C	USM2002-B3	Use 4WD drive adapter SK-509C
Toyota		80, 100		F	32	30	M	5	SK-533	Use 4WD drive adapter SK-509C	USM2002-B3	Use 4WD drive adapter SK-509C	USM2002-B3	Use 4WD drive adapter SK-509C
Toyota				F	25	23	M	3	SK-533	Use 4WD drive adapter SK-509C	USM2002-B3	Use 4WD drive adapter SK-509C	USM2002-B3	Use 4WD drive adapter SK-509C
Toyota				R	18	16	G	5	SK-523	Use 4WD drive adapter SK-509C	USM2002-R2	Use 4WD drive adapter SK-509C	USM2002-R2	Use 4WD drive adapter SK-509C
Toyota		90		F	22	20	M		Use 4WD drive adapter SK-509C		USM2002-B3	Use 4WD drive adapter SK-509C	USM2002-B3	Use 4WD drive adapter SK-509C
Toyota				R	18	16	G		Use 4WD drive adapter SK-509C		G	Use Universal Red Plates or SK-523 and SK-509C	USM2002-R2	Use extensions 220000RL and 4WD drive adapter SK-509C

Toyota	Land Cruiser 300, Prado and Hilus Surf	120		F		28	26	C	7		Use 4WD drive adapter SK-509C	USM2002-B3	Use extensions 220000BL and 4WD drive adapter SK-509C	USM2002-B3	Use extensions 220000BL and 4WD drive adapter SK-509C
Toyota					R	18	16	G	7	SK-523	Use 4WD drive adapter SK-509C	USM2002-R2	Use 4WD drive adapter SK-509C	USM2002-R2	Use 4WD drive adapter SK-509C
Toyota	Land Cruiser V8	200		F		32	29					USM2002-R2	Use extensions 220000RL and 4WD drive adapter SK-509C	USM2002-R2	Use extension 220000RL on the bottom mounting, and 4WD drive adapter SK-509C
Toyota					R	18	16	G	7	SK-523	Use 4WD drive adapter SK-509C	USM2002-R2	Use extension 220000RL on the bottom mounting, and 4WD drive adapter SK-509C	USM2002-R2	Use extension 220000RL on the bottom mounting, and 4WD drive adapter SK-509C
Toyota	Tundra	2007..		F		32	30	Q	18		Use 4WD drive adapter SK-509C	USM2002-R2	Use extensions 220000RL and 4WD drive adapter SK-509C	USM2002-R2	Use extensions 220000RL and 4WD drive adapter SK-509C
Toyota					R	18	16	G	7		Use 4WD drive adapter SK-509C	USM2002-R2	Use 4WD drive adapter SK-509C	USM2002-R2	Use 4WD drive adapter SK-509C
Toyota	FJ Cruiser	2005..		F							Use 4WD drive adapter SK-509C	USM2002-B3	Use 4WD drive adapter SK-509C	USM2002-B3	Use 4WD drive adapter SK-509C
Toyota					R						Use 4WD drive adapter SK-509C	USM2002-R2	Use 4WD drive adapter SK-509C	USM2002-R2	Use 4WD drive adapter SK-509C
Toyota	Dyna 100	YH, LH		F		25	23	G	10	SK-522A		USM2002-R2		USM2002-R2	
Vauxhall	Type	Model	Year	Front	Rear	Max	Min	Drawing	Shim (mm)	QMP	Remarks	USM	Remarks	USM	Remarks
Vauxhall															
Vauxhall	Vectra	B		F		24	21	B	7	SK-535		USM2002-B3		USM2002-B3	
Vauxhall					R	10	8	B	12			USM2002-B3		USM2002-B3	
Vauxhall		C		F		25	23					USM2002-R2		USM2002-R2	
Vauxhall					R	10	8					USM2002-R2		USM2002-R2	
Vauxhall	Zafira			F		25	22	D	7			USM2002-B3		USM2002-B3	
Vauxhall	Frontera			F		26	24.6	G	10	SK-542		USM2002-R2		USM2002-R2	
Vauxhall					R	18	16.6	G	7			USM2002-R2		USM2002-R2	
Vauxhall	Vivaro	2002..		F		28	24	A	None	SK-550A		USM2002-B3	Use extensions 220000BL	USM2002-B3	
Vauxhall					R	12	10	G	10	SK-537B		USM2002-R2	In case of metal dustcover, use: SK-537B, shim 5 (2x) , M10x60 (2x)	USM2002-R2	In case of metal dustcover, use: SK-537B, shim 5 (2x) , M10x60 (2x). SK-422
Vauxhall	Movano	3500		F		28		A	None			USM2002-B3	Use extensions 220000BL	USM2002-B3	Use extensions 220000BL
Vauxhall					R	12	10.5	G	10			USM2002-R2		USM2002-R2	
Volkswagen	Type	Model	Year	Front	Rear	Max	Min	Drawing	Shim (mm)	QMP	Remarks	USM	Remarks	USM	Remarks
Volkswagen															
Volkswagen	Up!	2012..		F		22	20	B	5			USM2002-B3		USM2002-B3	
Volkswagen	Fox	5Z		F		22	19	C	12			Use universal plates		USM2002-B3	

Volkswagen	Lupo	6X		F	18	16	C	5		USM2002-B3	Silencer does not fit	USM2002-B3	
Volkswagen	Polo	6N		F	10	8	C	3		Use universal plates		USM2002-B3	
Volkswagen		6V		F	20	18	B	10		Use universal plates		USM2002-B3      Use SK-411	
Volkswagen				F	25	23	B	7	SK-553	USM2002-B3		USM2002-B3	
Volkswagen					R	9	7	H	3	Use long uni red plates UP-RL1 above and SK532 beneath	H	No space	USM2002-R2
Volkswagen	Beetle	9C		F	22	19	C	12	Use M9 bolts SK-411 on caliper	C	Use SK-411 and universal plates	USM2002-B3	Use SK-411
Volkswagen					R	9	7	G	17		USM2002-R2		USM2002-R2
Volkswagen	Golf	type II		F	10	8	C	3		USM2002-B3		USM2002-B3	
Volkswagen		type III		F	12	10	C	7		USM2002-B3			
Volkswagen		type IV		F	22	18	C	12	Use M9 bolts SK-411 on caliper	Use SK-411, SK-420 and universal plates		Use SK-411, SK-420	
Volkswagen				F	25	23	B	7		USM2002-B3		USM2002-B3	
Volkswagen					R	9	7	G	17		USM2002-R2		USM2002-R2
Volkswagen	Golf / Golf plus	type V		F	22	18	C	12	A      Use M9 bolts SK-411 on caliper	Use SK-411, SK-420 and universal platesA		USM2002-B3	Use SK-411, SK-420
Volkswagen				F	25	22	G	12		USM2002-R2		USM2002-R2	
Volkswagen					R	10	8		13      SK-590	x		Use SK-590	
Volkswagen	Golf	type VI		F	22	18	G	12	A	Use SK-411, SK-420 and universal platesA		USM2002-B3	Use SK-411, SK-420
Volkswagen					R	10	8		17      SK-590	Use SK-590		Use SK-590	
Volkswagen	Golf	type VII	2012..	F	25	22	G	10	Ø282x25	USM2002-R2		USM2002-R2	
Volkswagen					R	10	8	G	20	Ø272x10	G	Use bolts M10x70	USM2002-R2      Use extensions 220000RP, turn bow, use bolts M10x50
Volkswagen	Golf Sportsvan		2014..	F	25	22			Ø282x25	USM2002-R2		USM2002-R2	
Volkswagen					R	10	8		Ø272x10	USM2002-R2		USM2002-R2	
Volkswagen	Bora	1J2		F	22	19	C	12	Use M9 bolts SK-411 on caliper	C	Use SK-411 and universal plates	USM2002-B3	Use SK-411,
Volkswagen					R	9	7	G	17		USM2002-R2	Silencer does not fit	USM2002-R2
Volkswagen	Vento			F	12	10	C	7		USM2002-B3		USM2002-B3	
Volkswagen	Jetta	1KM	2005	F	22	18	C	10	Use M9 bolts SK-411 on caliper	Use SK-411, SK-420 and universal plates		Use SK-411, SK-420,	
Volkswagen	Jetta				R	12	10	D	15      SK-590			Use SK-590	
Volkswagen	Tiguan			F	25	23	G	12		USM2002-R2	Use extensions 220000RL	USM2002-R2	
Volkswagen					R	12	10	G	20	Use bolts M10x75	G		USM2002-R2      Use extensions 220000RP
Volkswagen	Passat	type II+III		F	20	18	B	10		USM2002-B3		USM2002-B3	
Volkswagen		3B		F	22	20	B	10		USM2002-B3		USM2002-B3	

---

Volvo	240				22	20.4				USM2002-R2		USM2002-R2	
Volvo	340 / 360			F	12.85	12.20	G	7		USM2002-R2		USM2002-R2	
Volvo	440 / 460 / 480			F	12.0	10.8	G	3		USM2002-R2		USM2002-R2	
Volvo				R	9.0	8.0	G	10		USM2002-R2		USM2002-R2	
Volvo	C30			F	25	23	G	7		USM2002-R2		USM2002-R2	
Volvo				R	11	9	G	15		USM2002-R2		USM2002-R2	
Volvo	S40 / V40		..2004	F	24.0	21.5	G	8	SK-560	USM2002-R2		USM2002-R2	
Volvo				R	10.0	8.4	-	-	SK-562	SK-562		USM2002-R2	
Volvo	V40	Ø320	2012..	F	25	23	G	12		USM2002-R2	Use extensions 220000RL	USM2002-R2	
Volvo				R	11	9				USM2002-R2		USM2002-R2	
Volvo	S40 / V50		2004..	F	25	23	G	7		USM2002-R2		USM2002-R2	
Volvo				R	11	9	G	15		USM2002-R2		USM2002-R2	
Volvo	S60	15"		F	26	23	G	13	SK-566	USM2002-R2		USM2002-R2	
Volvo				R	12	10	-	-	SK-567	SK-567		USM2002-R2	
Volvo	S60	16"		F	28.0	25.0	G	13	SK-566	USM2002-R2	Use extensions 220000RL	USM2002-R2	
Volvo				R	12.0	10.0	-	-	SK-567	SK-567		USM2002-R2	
Volvo	S60 AWD	16"		F	28.0	25.0	G	13	SK-566	USM2002-R2	Use extensions 220000RL	USM2002-R2	
Volvo				R	12.0	10.0	-	-	SK-567	SK-567		USM2002-R2	
Volvo	S60R		2003	F	32.0	30.0	M	18	Use UP-BL1	USM2002-R2	Use extensions 220000RL	USM2002-R2	Use extensions 220000RL
Volvo				R	28	26	M	30	Use UP-BL1 at upper side	M	Use UP-BL1 at upper side	USM2002-R2	Use extension 220000RL on the bottom mounting
Volvo	XC60		2009..	F	30.0	28.0	G	13		USM2002-R2	Use extensions 220000RL	USM2002-R2	Use extension 220000RL on the bottom mounting
Volvo				R	22.0	20.0				USM2002-R2		USM2002-R2	
Volvo	850 / V70 / S70 / C70		.. 2000	F	26	23	G	10	SK-560	USM2002-R2		USM2002-R2	
Volvo				R	9.6	8.4	B	10	SK-559	USM2002-R2		USM2002-R2	Excl. V70 AWD
Volvo	C70		2006	F	25	23	G	7		USM2002-R2		USM2002-R2	
Volvo				R	11	9	G	15		USM2002-R2		USM2002-R2	
Volvo	V70 AWD			R	9.6	8.4	H	3	SK-567	USM2002-R2		USM2002-R2	
Volvo	V70	15"	2000..2008	F	26.0	23.0	G	13	SK-566	USM2002-R2		USM2002-R2	
Volvo				R	12.0	10.0	-	-	SK-567	SK-567		USM2002-R2	
Volvo	V70	16"	2000..2008	F	28.0	25.0	M	15	SK-566	USM2002-R2	Use extensions 220000RL	USM2002-R2	
Volvo				R	12.0	10.0	-	-	SK-567	SK-567		USM2002-R2	
Volvo	V70R		2003..2008	F	32.0	30.0	M	18	Use UP-BL1	USM2002-R2	Use extensions 220000RL	USM2002-R2	Use extensions 220000RL
Volvo				R	28	26	M	30	Use UP-BL1 at upper side	M	Use UP-BL1 at upper side	USM2002-R2	Use extension 220000RL on the bottom mounting
Volvo	V70		2008..	F	28.0	26.0	G	15	SK-566	USM2002-R2	Use extensions 220000RL	USM2002-R2	
Volvo				R	11.0	9.0	G	15		USM2002-R2		USM2002-R2	



Volvo	XC70	16"	2002..2008	F		28.0	25.0	G	13	SK-566		USM2002-R2	Use extensions 220000RL	USM2002-R2	
Volvo					R	12.0	10.0	-	-	SK-567		SK-567		USM2002-R2	
Volvo			2008..	F		28.0	26.0	G	15	SK-566		USM2002-R2	Use extensions 220000RL	USM2002-R2	
Volvo					R	22.0	20.0	G	20			USM2002-R2		USM2002-R2	
Volvo	940 / 960			F		26.0	23.0	G	10	SK-560		USM2002-R2		USM2002-R2	
Volvo					R	9.6	8.4	B	10	SK-559	Axles with aut. lock differential only mountable with SK-559	SK-559	Axles with aut. lock differential only mountable with SK- 559	SK-559	Axles with aut. lock differential only mountable with SK-559
Volvo					R	10.0	8.0	K	5	SK-559	Axles with aut. lock differential only mountable with SK-559	SK-559	Axles with aut. lock differential only mountable with SK- 559	SK-559	Axles with aut. lock differential only mountable with SK-559
Volvo	S80		.. 2006	F		28.0	25.0	M	15	SK-566		USM2002-R2		USM2002-R2	
Volvo					R	12.0	10.0	-	-	SK-567		SK-567		USM2002-R2	
Volvo	S80	3.2, Ø300	2007 ..	F		28.0	26.0	G	13	SK-566		USM2002-R2		USM2002-R2	
Volvo					R	12.0	10.0	G	20			USM2002-R2		USM2002-R2	
Volvo	S80	T6, Ø316	2007..	F		28.0	26.0	G	15	SK-566		USM2002-R2		USM2002-R2	
Volvo					R	22.0	20.0	G	20			USM2002-R2		USM2002-R2	
Volvo	S80	V8, Ø336	2007..	F		28.0	26.0	G	13		Use long universal plates UP-RL1	USM2002-R2	Use extensions 220000RL	USM2002-R2	Use extensions 220000RL
Volvo					R	22.0	20.0	G	20			USM2002-R2		USM2002-R2	
Volvo	XC90	17"		F		30.0	27.0	G	12		Use long universal plates UP-RL1	USM2002-R2	Use extensions 220000RL	USM2002-R2	Use extensions 220000RL
Volvo					R	20.0	18.0	K	3	SK-559		USM2002-R2		USM2002-R2	















































































































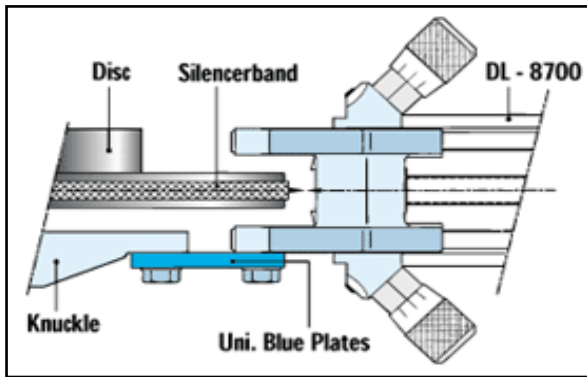

Fig. A

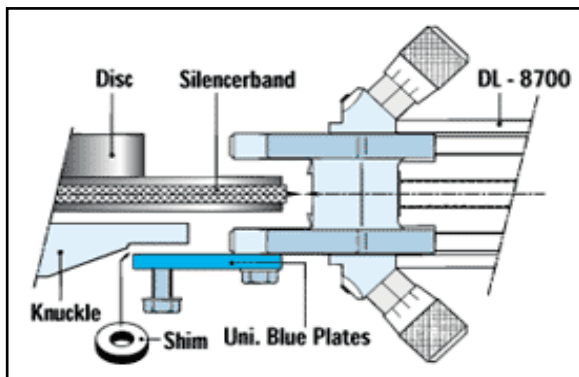

Fig. B

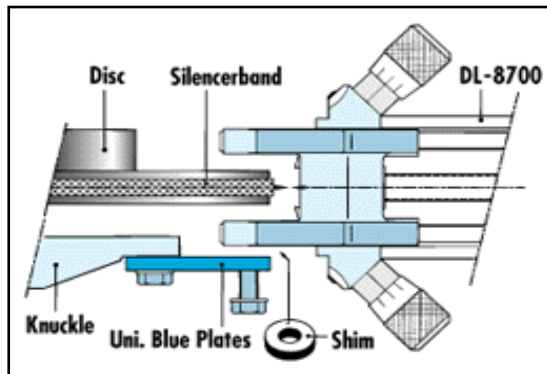

Fig. C

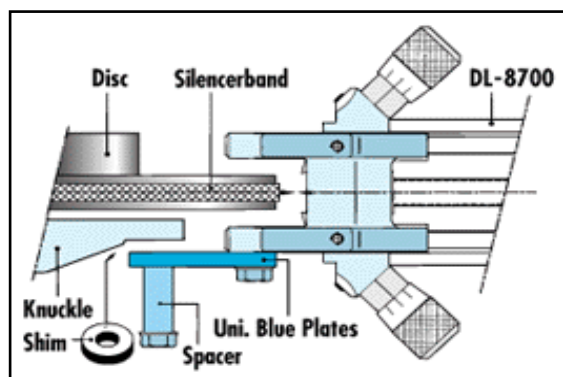

Fig. D

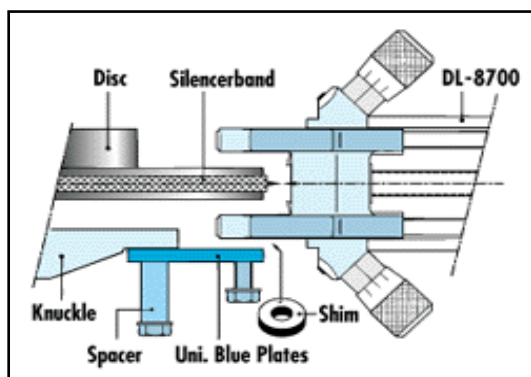

Fig. E

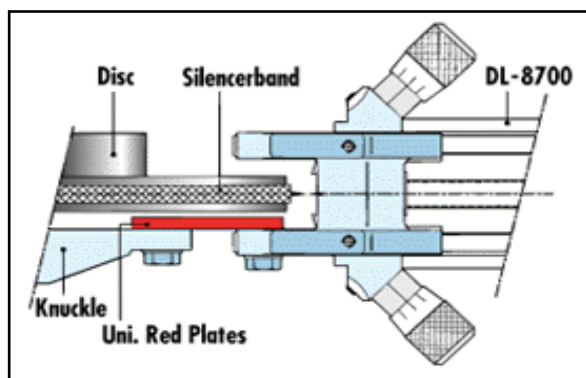

Fig. F

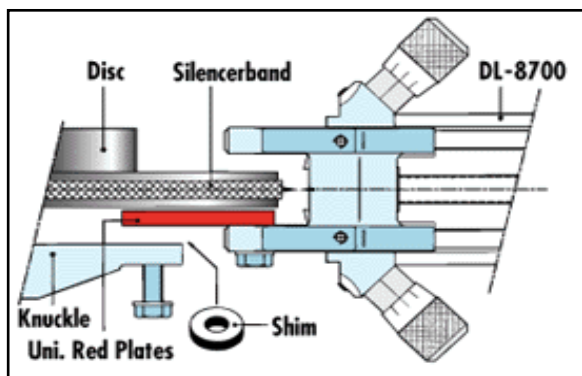

Fig. G

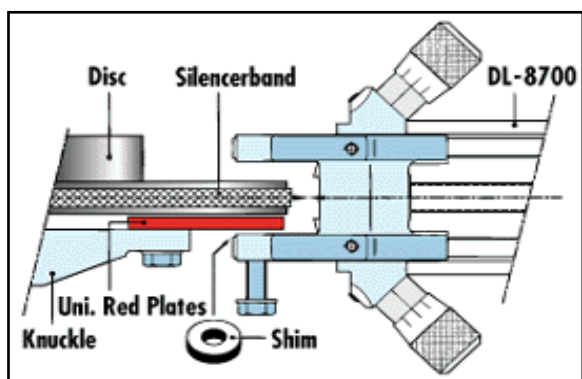

Fig. H

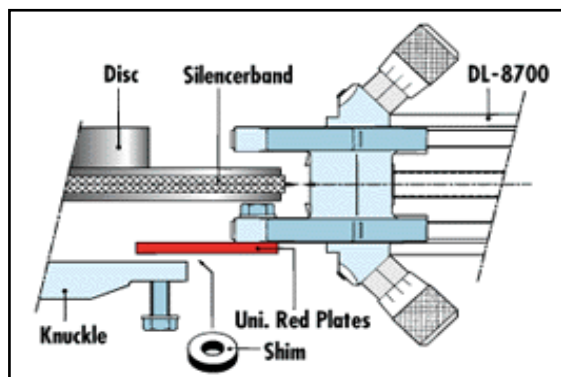

Fig. K



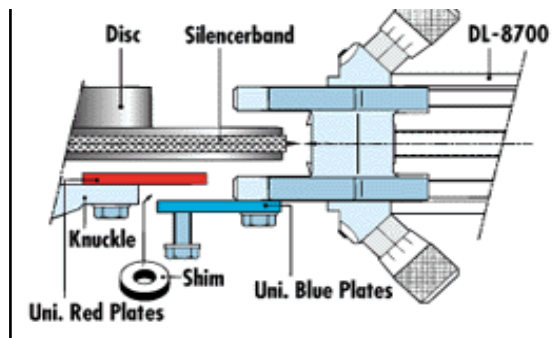

Fig. L

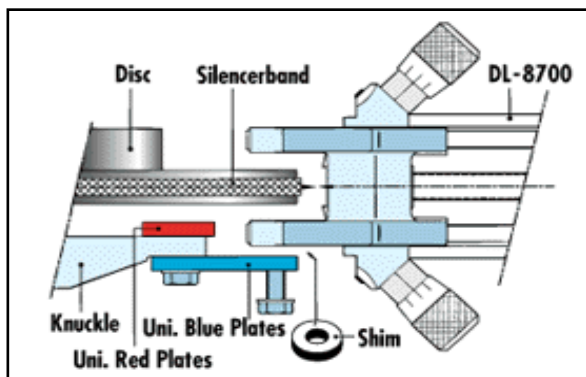

Fig. M

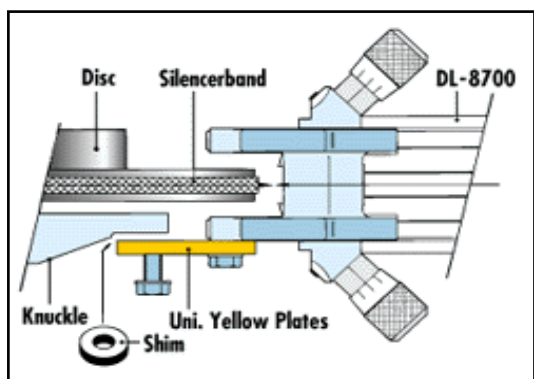

Fig. N

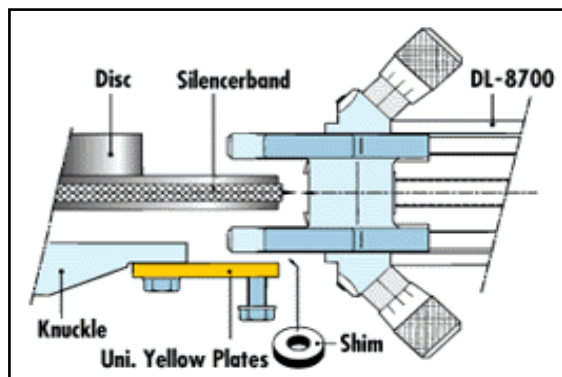

Fig. P

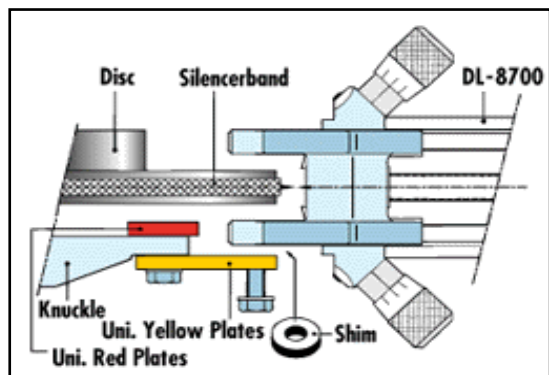

Fig. Q

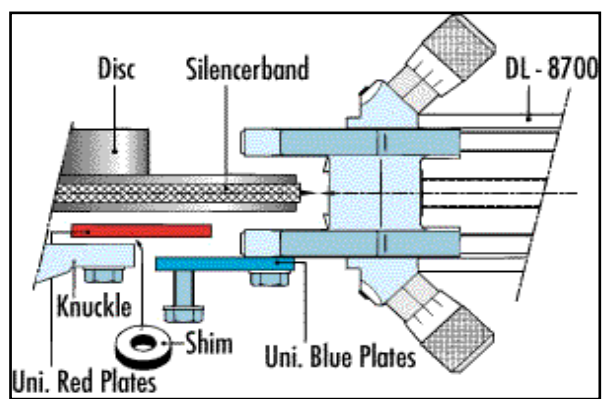
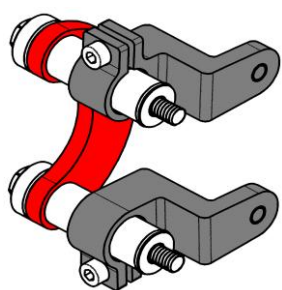
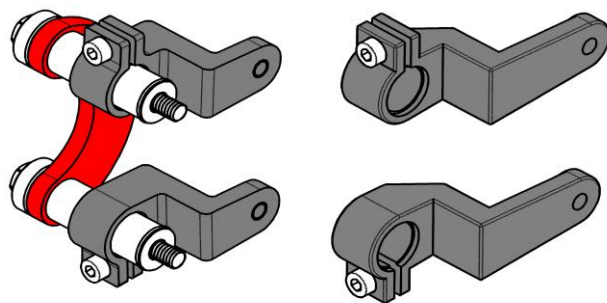

Fig. R



**USM2002-R2**



**USM2002-R2 + 220000RP**

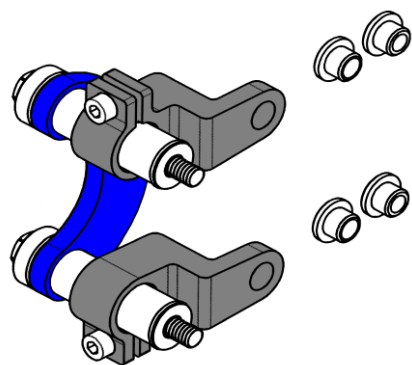

**USM2002-B3**

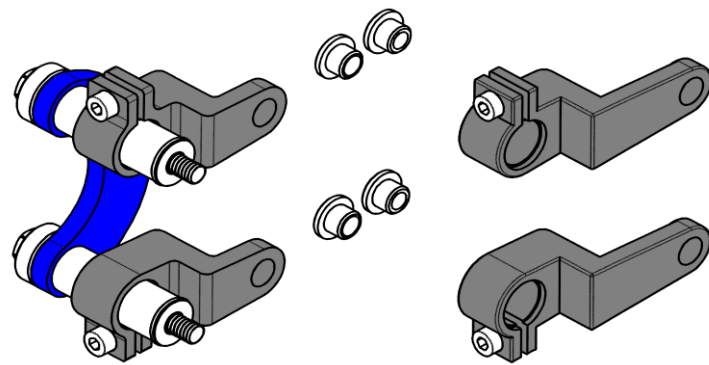

**USM2002-B3 + 220000BL**

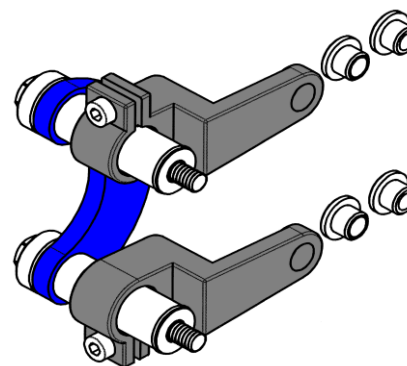

**USM2002-BL3**

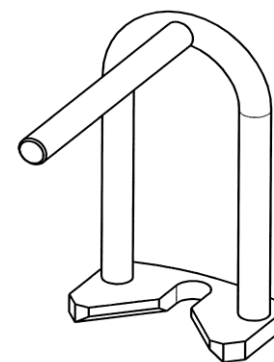

**SK-509C**



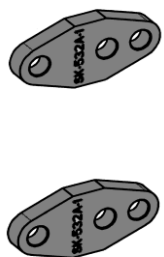

SK-523A

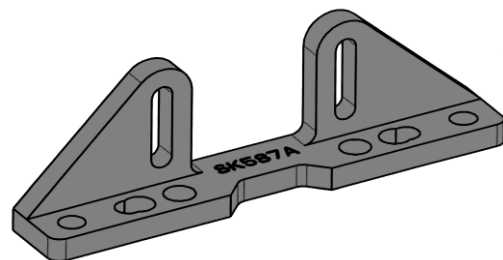

SK-587A

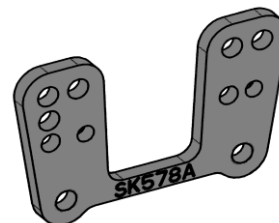

SK-578A

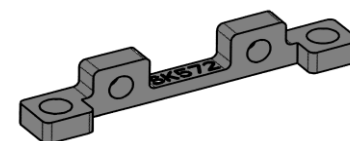

SK-572